

ELGIN MILLS ROAD EAST

Berczy

CREEK

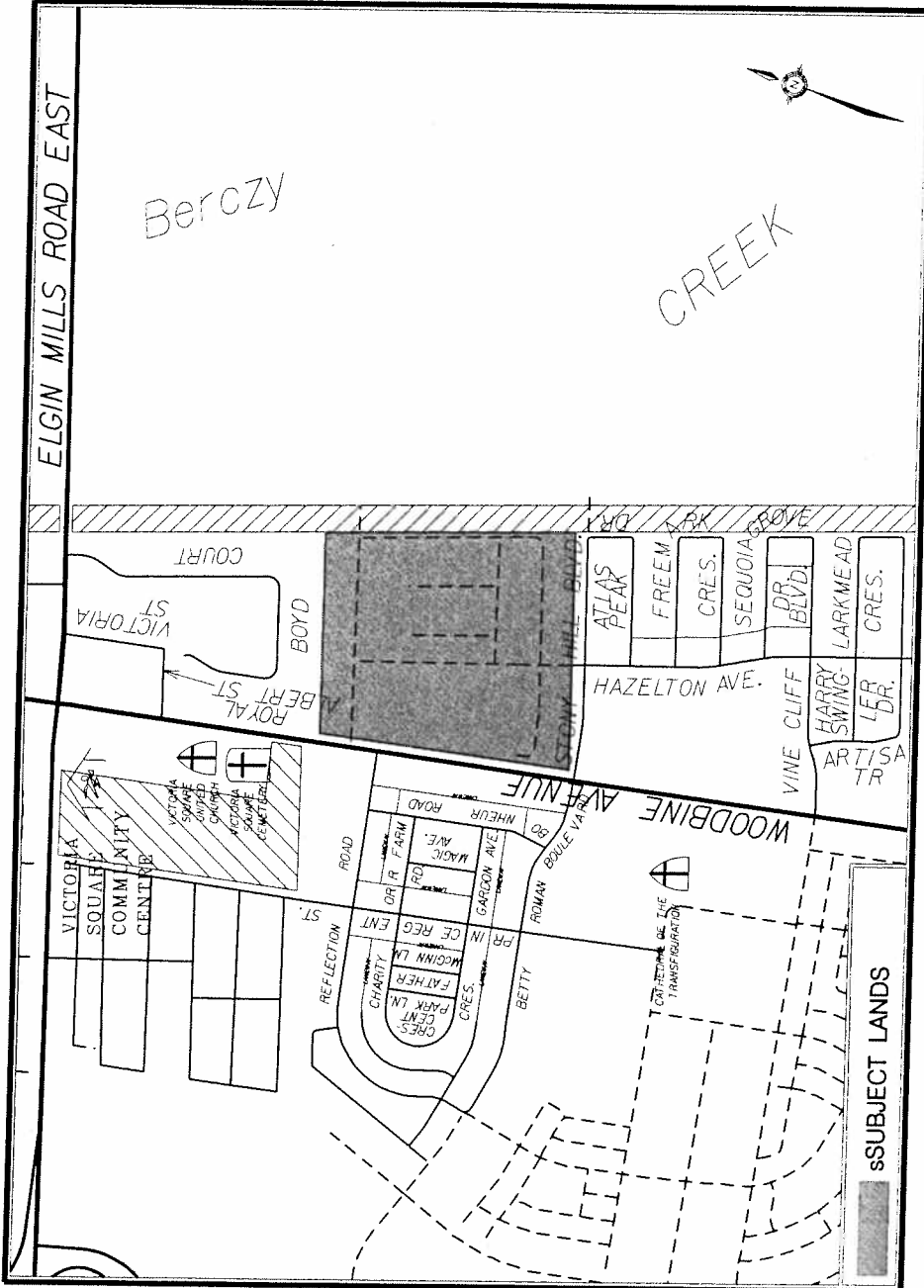



AREA CONTEXT / ZONING

APPLICANT: EMK CONSTRUCTION & TREE LAWN CONSTRUCTION LTD.
10519 & 10521 WOODBINE AVENUE

FILE No: SU.06108473 (SK)



DEVELOPMENT SERVICES COMMISSION

DWN BY: CPW CHK BY: SK

SCALE 1:



SUBJECT LANDS

DATE: 11/09/06

FIGURE No.2



SU06108473.DGN 11/10/2006 10:55:30 AM



AIR PHOTO (2005)

APPLICANT: EMK CONSTRUCTION & TREE LAWN CONSTRUCTION LTD.
10519 & 10521 WOODBINE AVENUE

FILE No: SU.06108473 (SK)

 SUBJECT LANDS

DATE: 110906



MARKHAM DEVELOPMENT SERVICES COMMISSION

DWN BY: CPW CHK BY: SK SCALE 1:

FIGURE No.3



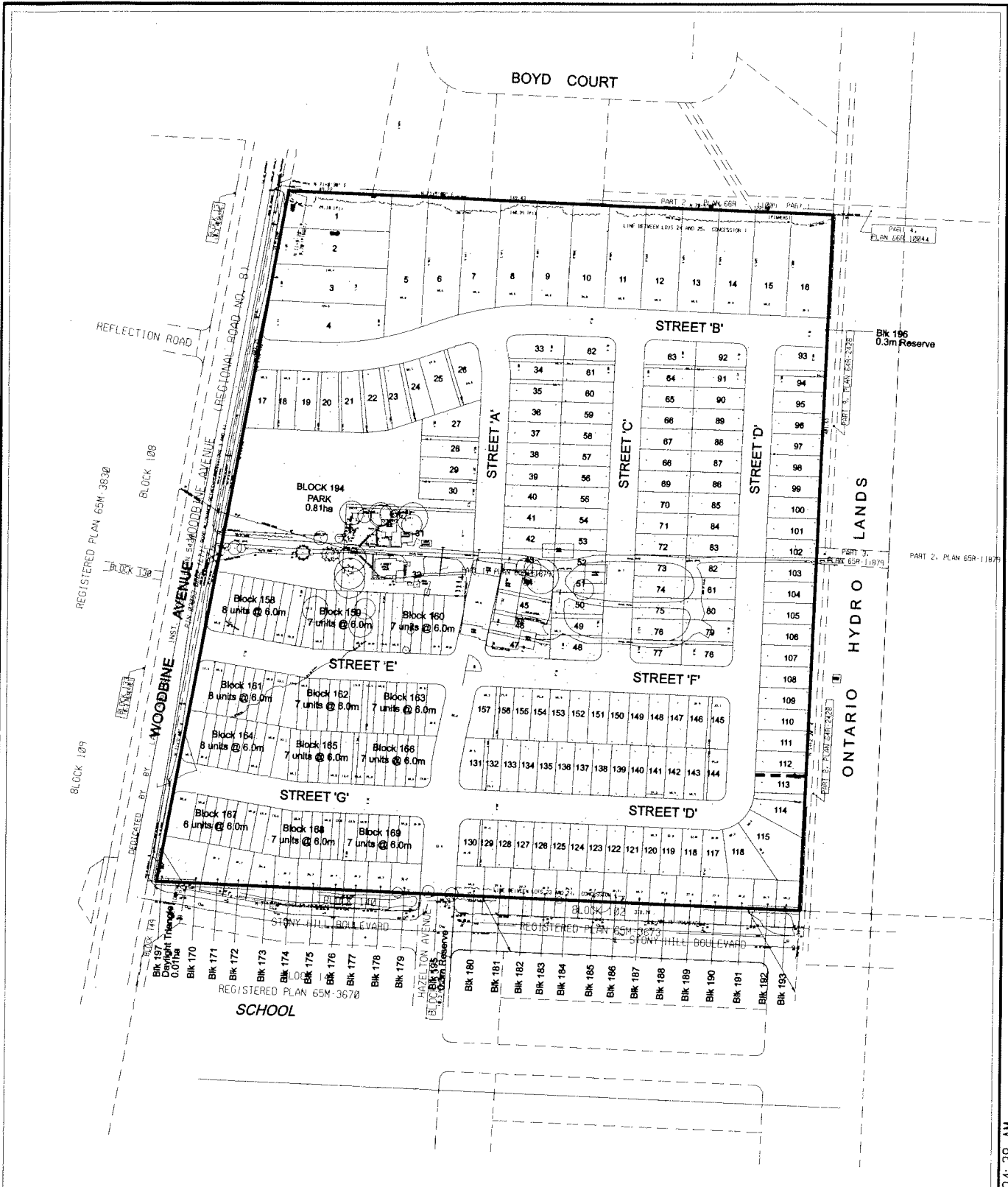

PROPOSED DRAFT PLAN

APPLICANT: EMK CONSTRUCTION & TREE LAWN CONSTRUCTION LTD.
10519 & 10521 WOODBINE AVENUE

FILE No: SU.06108473 (SK)

DATE: 11/09/06



DEVELOPMENT SERVICES COMMISSION

DWN BY: CPW CHK BY: SK SCALE 1:

FIGURE No.4