

## **EXPLANATORY NOTE**

### **BY-LAW 2007-71**

#### **A by-law to amend By-law 177-96, as amended**

93 Helen Avenue  
Part of Lot 12 on Plan 2196  
South Unionville Planning District

### **LANDS AFFECTED**

The by-law applies to a 0.3 ha (0.74 acre) parcel of land municipally known as 93 Helen Avenue within the South Unionville Planning District.

### **PURPOSE AND EFFECT**

The purpose and effect of this by-law is to delete Schedule 'A' of By-law 2006-331 and replace it with a new Schedule 'A', attached hereto. The Schedule 'A' originally appended to By-law 2006-331 did not delineate the location of the park block nor did it identify the lands subject to Holding (H) provisions. The by-law also serves to revise the reference to the Open Space category in the text of the By-law to Open Space One (OS1) Zone, per By-law 177-96.

---



## BY-LAW 2007-71

A by-law to amend Urban Expansion Area  
Zoning By-law 177-96, as amended

---

THE COUNCIL OF THE CORPORATION OF THE TOWN OF MARKHAM  
HEREBY ENACTS AS FOLLOWS:

1. That By-law 177-96, as amended, by By-law 2006-331, be amended as follows:
  - 1.1 By deleting the reference to O1 (Open Space) in section 1.2 of By-law 2006-331 and replacing it with OS1 (Open Space One)
  - 1.2 By deleting Schedule 'A' of By-law 2006-331 and replacing it with a new Schedule 'A' attached hereto as Schedule 'A' to this by-law.
2. All other provisions of By-law 177-96, as amended, not inconsistent with the provisions of this By-law shall continue to apply.

READ A FIRST, SECOND, AND THIRD TIME AND PASSED THIS  
24<sup>TH</sup> DAY OF APRIL, 2007.

  
SHEILA BIRRELL, TOWN CLERK

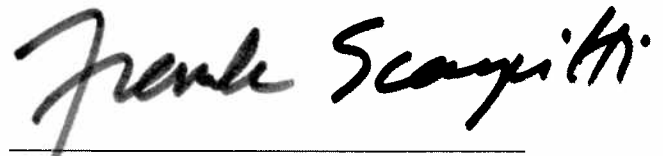
  
FRANK SCARPITTI, MAYOR

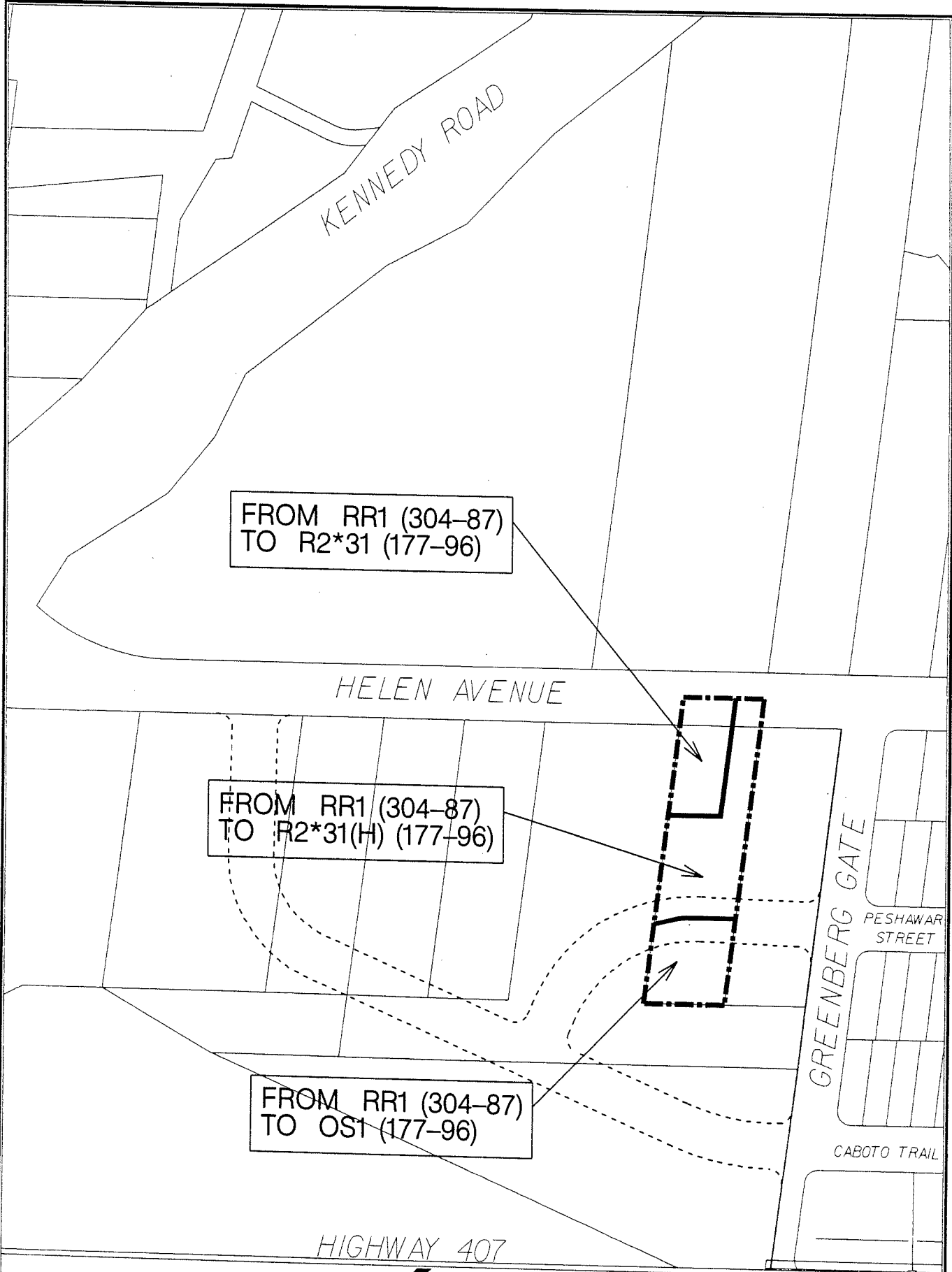

DEVELOPMENT SERVICES COMMISSION

# A BY-LAW TO AMEND BY-LAW 177-96



BOUNDARY OF AREA COVERED BY THIS BY-LAW

RR1

RURAL RESIDENTIAL

R2

RESIDENTIAL TWO

OS1

OPEN SPACE

(H)

HOLDING PROVISION

No(\*)

EXCEPTION NUMBER



THIS IS SCHEDULE 'A' TO BY-LAW ...2007-71  
PASSED THIS 24TH DAY OF APRIL, 2007

*Frank Scarpitti* MAYOR  
*Debra Birrell* CLERK

NOTE: 1) DIMENSIONS ARE IN METRES  
2) REFERENCE SHOULD BE MADE TO  
THE ORIGINAL BY-LAW LODGED IN  
THE OFFICE OF THE CLERK

SCALE 1: 2000