



October 19, 2007

**NOTICE**  
**Temporary Road Closure to Through Traffic**  
**Reesor Road between 16<sup>th</sup> Avenue and Major Mackenzie Drive East**

Dear Sir/Madam,

Further to the notice dated May 28, 2007, please be advised that Reesor Road will be remain closed to through traffic between 16<sup>th</sup> Avenue and Major Mackenzie Drive East (see attached Key Map) until **end of November 2007** due to bridge construction.

If you have any questions regarding the construction of this project, please contact the Town's Consulting Engineer Mr. Paul LaPalme, P.Eng., of Chisholm, Fleming and Associates at (905) 474-1458 or the undersigned at (905) 477-7000, ext. 2989. Should a problem arise after regular business hours or on the weekend, please call the Town of Markham's after hour's service at (905) 477-7000.

Sincerely,

A handwritten signature in black ink, appearing to read 'P. Narasimhan'.

Prathapan Kumar, P.Eng.  
Project Engineer  
Capital Right-of-Way  
Asset Management Department  
Tel: (905) 477-7000, ext. 2989  
Fax: (905) 479-7766  
Email: pkumar@markham.ca

Attachments: Key Map

Distribution: See List

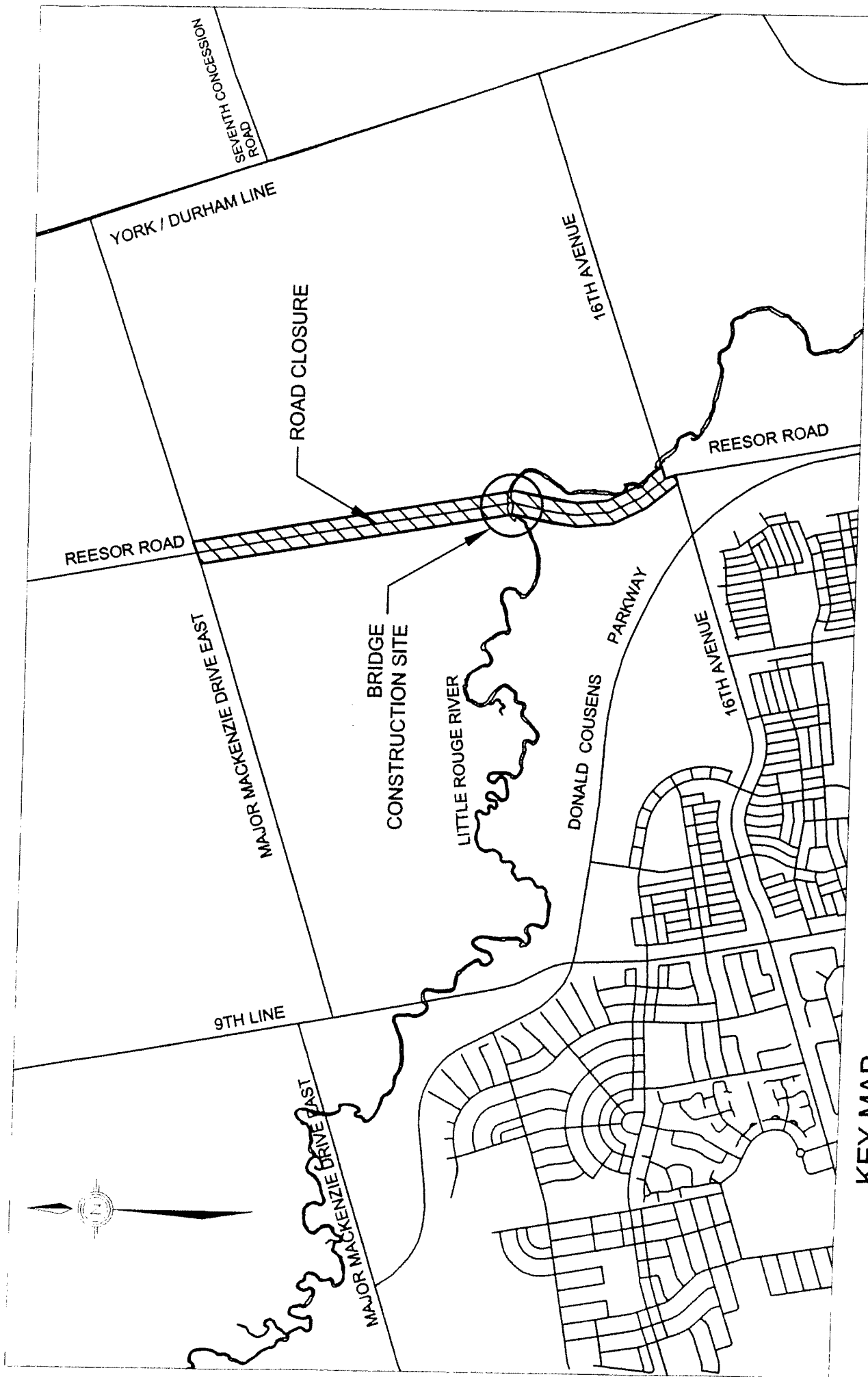

## KEY MAP

### REESOR ROAD BRIDGE REPLACEMENT

Contract No: 231-T-06

Commencement Date: June 4, 2007

Revised Completion Date: End of November, 2007



May 28, 2007

**NOTICE**  
**Temporary Road Closure to Through Traffic**  
**Reesor Road between 16<sup>th</sup> Avenue and Major Mackenzie Drive East**

Dear Sir/Madam,

Please be advised that Reesor Road will be closed to through traffic between 16<sup>th</sup> Avenue and Major Mackenzie Drive East (see attached Key Map) from June 4, 2007 to approximately October 26, 2007. The purpose of this temporary closure is to replace the bridge over the Little Rouge River. Access to local properties will be maintained at all times, but absolutely no traffic will be able to cross the river. Therefore, all providers of emergency services should refer to the attached Local Property Address Map to determine the direction of access for the various local street address numbers.

If you have any questions regarding the construction of this project, please contact the Town's Consulting Engineer Mr. Paul LaPalme, P.Eng., of Chisholm, Fleming and Associates at (905) 474-1458 or the undersigned at (905) 477-7000, ext. 2989. Should a problem arise after regular business hours or on the weekend, please call the Town of Markham's after hour's service at (905) 477-7000.

Sincerely,

A handwritten signature in black ink, appearing to read 'P. Narendra'.

Prathapan Kumar, P.Eng.  
Project Engineer  
Capital Right-of-Way  
Asset Management Department  
Tel: (905) 477-7000, ext. 2989

Attachments: Key Map  
Local Property Address Map

Distribution: See List

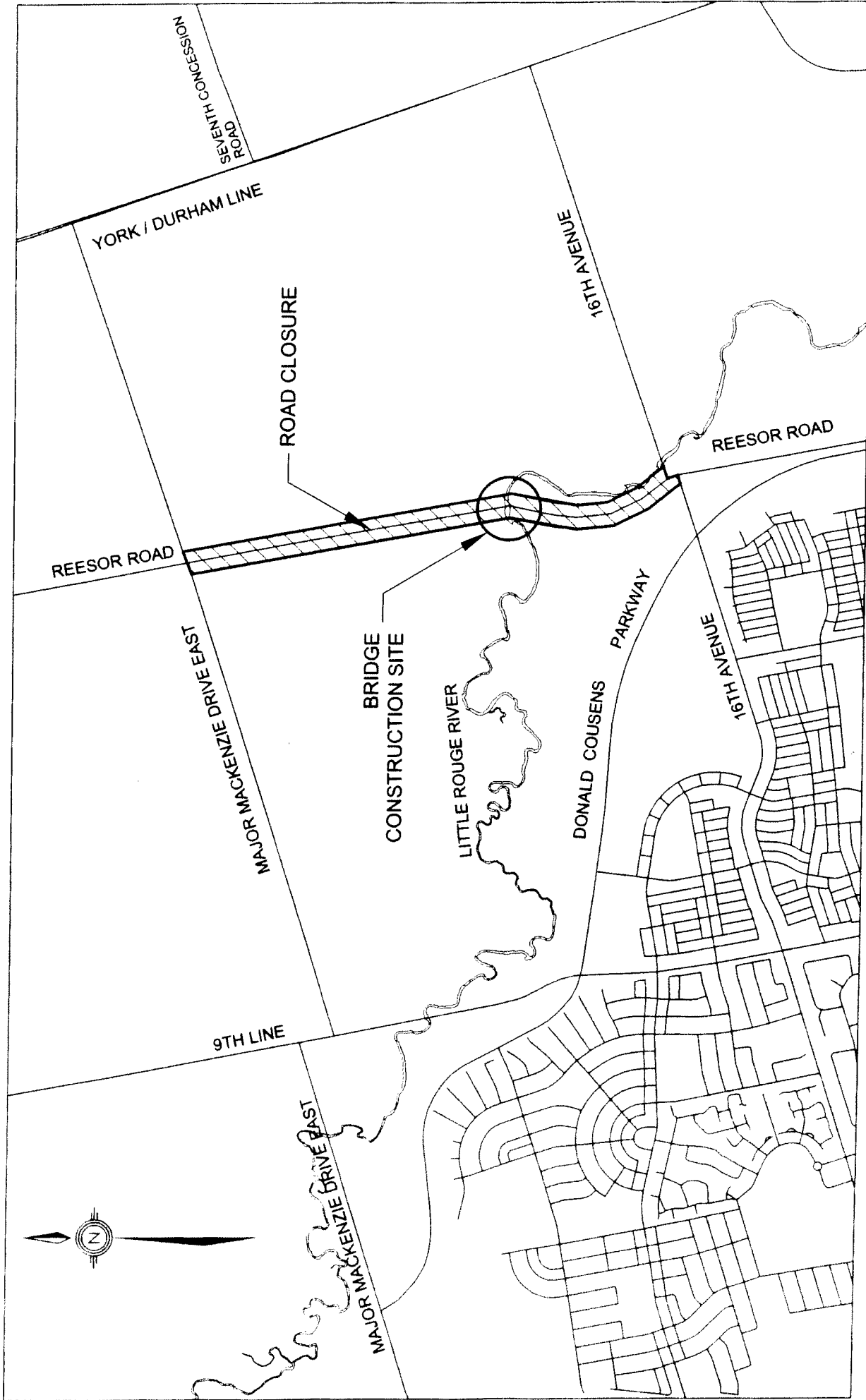

## **KEY MAP**

### **REESOR ROAD BRIDGE REPLACEMENT**

**Contract No: 231-T-06**

**Commencement Date: June 4, 2007**

**Estimated Completion Date: October 26, 2007**

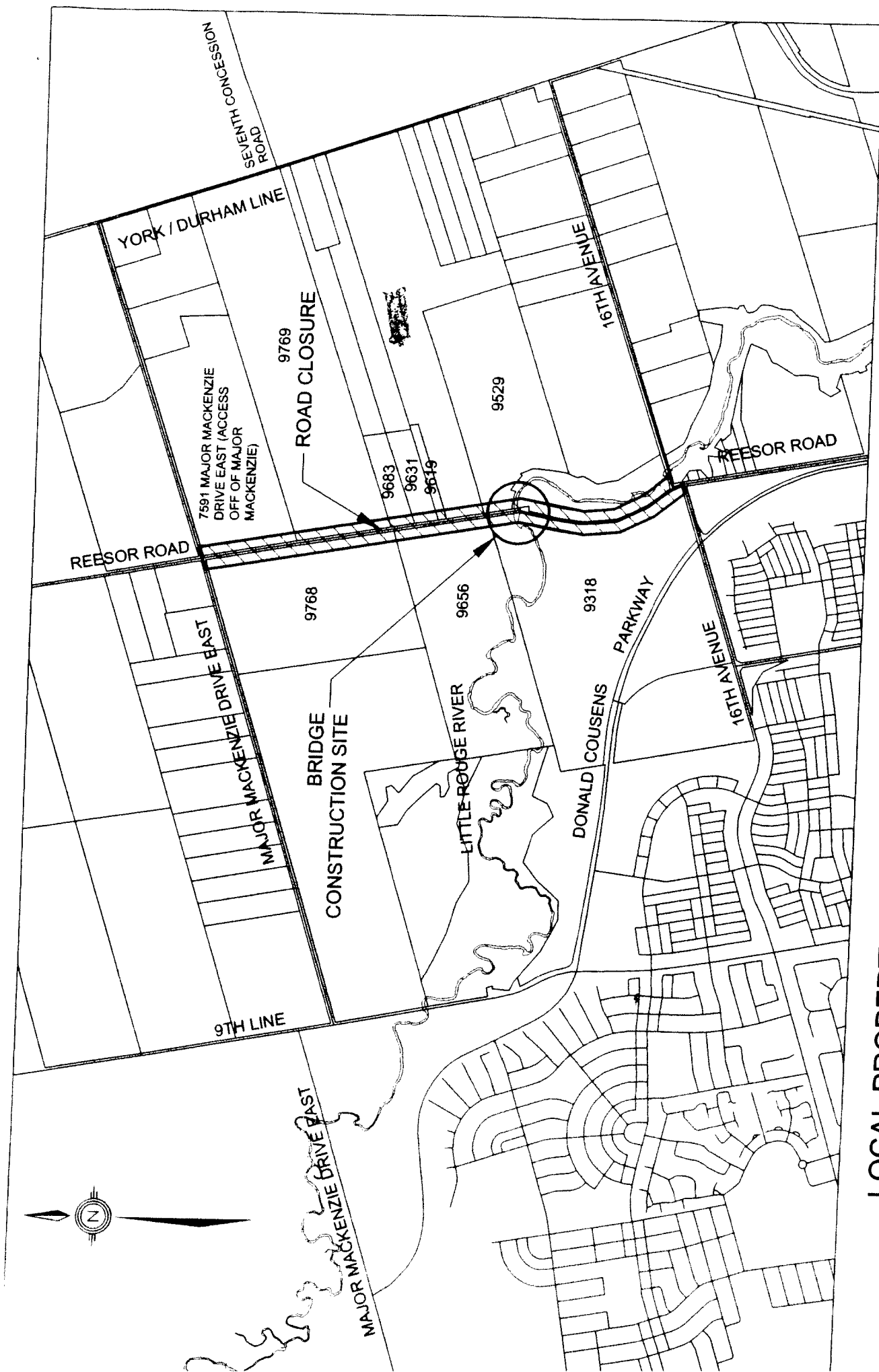

**LOCAL PROPERTY ADDRESS MAP (Nos. 9318 to 9769 inclusive)**  
**REESOR ROAD BRIDGE REPLACEMENT**  
**Contract No: 231-T-06**

Commencement Date: June 4, 2007  
Estimated Completion Date: October 26, 2007