



(Q:\geomatics\new operation\agenda\urban design\9580 wbine.dgn)

PHOTO 9333 WOODBINE AVE (NEIGHBOURING PROPERTY WITH SIMILAR FENCING)

APPLICANT: MARKHAM CHINESE BAPTIST CHURCH
9580 WOODBINE AVENUE

FILE No: 9580 WBINE

DATE: 23/02/07



DEVELOPMENT SERVICES COMMISSION

DWN BY: CPW

CHK BY: LM

SCALE 1:

FIGURE No.1



AREA CONTEXT

APPLICANT: MARKHAM CHINESE BAPTIST CHURCH
9580 WOODBINE AVENUE

FILE No: 9580 WBINE



DEVELOPMENT SERVICES COMMISSION

DWN BY: CPW

CHK BY: LM

SCALE 1:

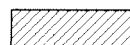

SUBJECT PROPERTY

DATE: 230207

FIGURE No.2

9580 WBINE.DGN 01/03/2007 2:18:17 PM

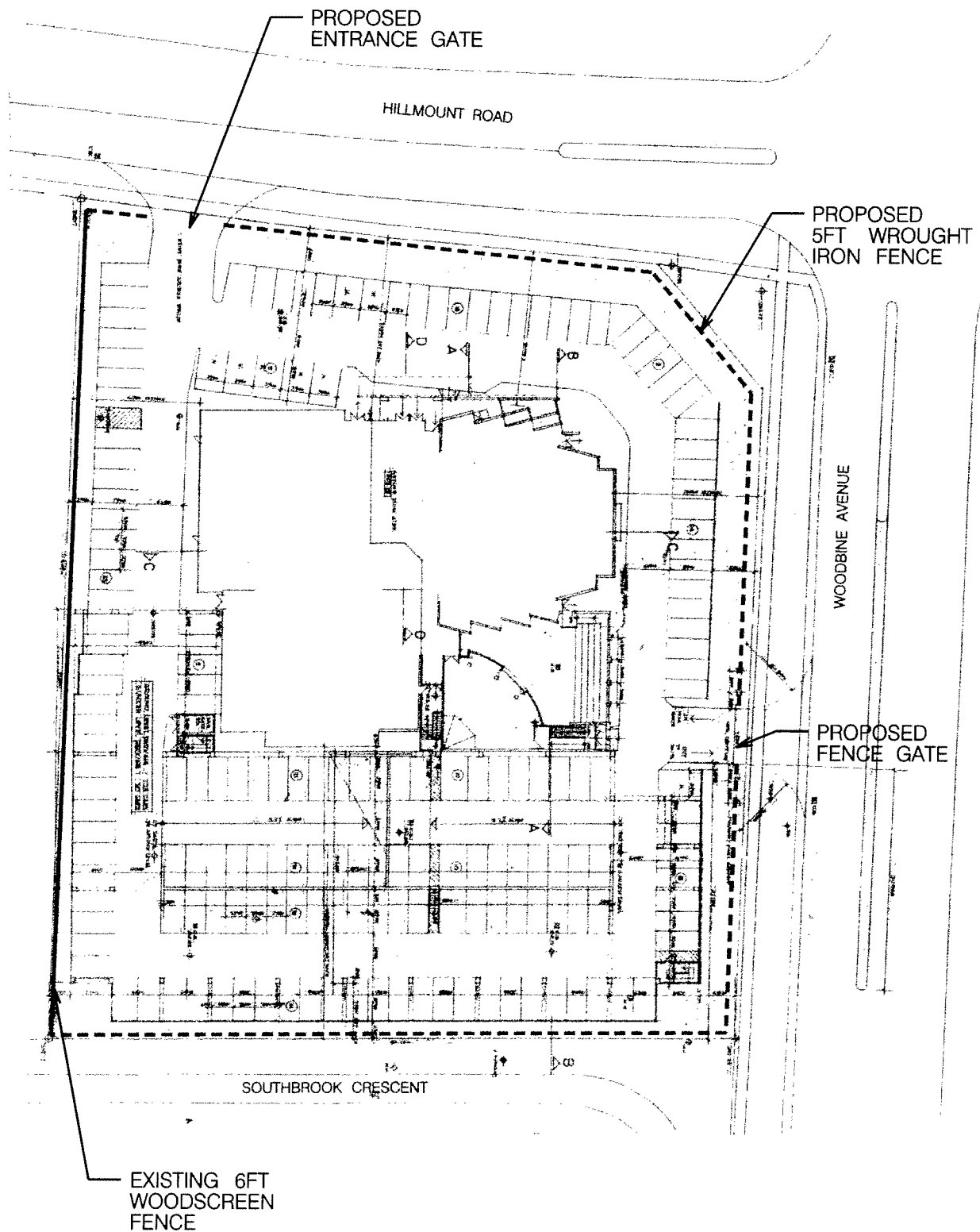

SITE PLAN

APPLICANT: MARKHAM CHINESE BAPTIST CHURCH
9580 WOODBINE AVENUE

FILE No: 9580 WBINE

DATE: 23/02/07



DEVELOPMENT SERVICES COMMISSION

DWN BY: CPW

CHK BY: LM

SCALE 1:

FIGURE No.3

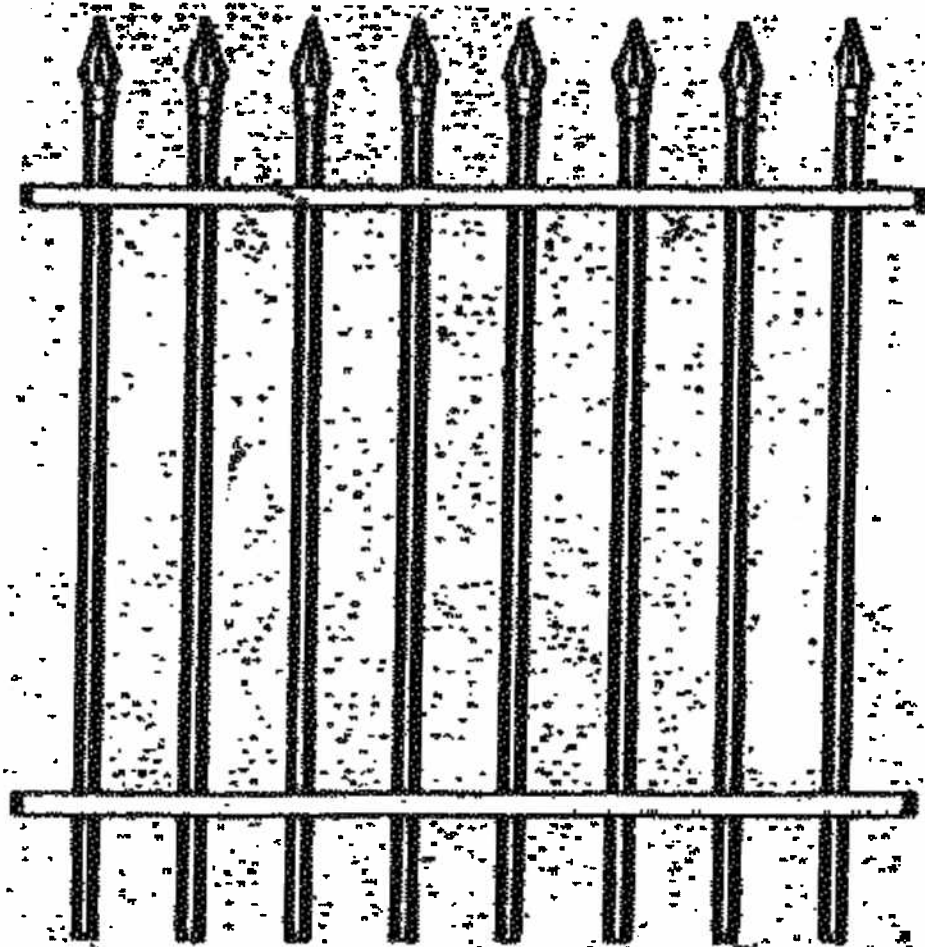

ROCKEFELLER

FENCE DETAIL

APPLICANT: MARKHAM CHINESE BAPTIST CHURCH
9580 WOODBINE AVENUE

FILE No: 9580 WBINE

DATE: 230207



DEVELOPMENT SERVICES COMMISSION

DWN BY: CPW

CHK BY: LM

SCALE 1:

FIGURE No.4