



● **EAST MARKHAM**
COMMUNITY CENTRE & LIBRARY

COUNCIL PRESENTATION

10.22.07



**SHORE
TILBE
IRWIN
& PARTNERS**

Program Overview

	Base Building Component	Area (s.f.)
A	Aquatics	37,818
B	Gymnasium	11,550
C	Fitness	17,370
D	Library	20,040
	Medical Library	3,000
E	Multi- Use	7,480
F	Older Adults	2,970
G	Youth	2,670
H	Common Areas	12,900
	Sub Total	115,798
	Public Request Items- Recommended by Staff	
J	Aquatics- Expanded Children's Play Area	3,850
K	Gymnasium- Upgrades for Community Triple Gym	4,730
L	Multi-Use- Upgrades for Community Performance Use	220
	Total	124,598

Program Highlights

AQUATICS

East Markham CC+L	Angus Glen CC+L Comparison
<ul style="list-style-type: none">-8 Lane- 25m Tank (with 6m teaching deck space)-Therapy Tank-Leisure Tank (2,500 s.f.)-Children's Spray Pad (2,000 s.f.)-Water Slide-Family, Men's, Women's Change Rooms-Swim Club Offices <p>TOTAL GFA 41,668 S.F.</p>	<ul style="list-style-type: none">-6 Lane- 25m Tank (with 3m teaching deck space)-No Therapy Tank-Leisure Tank (2,000 s.f.)-Children's Spray Feature Wall (200 s.f.)-No Water Slide-Smaller Family, Men's, Women's Change Rooms-No Swim Club Offices <p>TOTAL GFA 29,355 S.F.</p>



Program Highlights

GYMNASIUM

East Markham CC+L	Angus Glen CC+L Comparison
Triple Gymnasium -Includes NBA main court (50'x94') and 3 cross courts (40'x60') with generous run out space * -Includes Dedicated Children's Indoor Playground -Retractable Bleacher Seating (200 seats)	Double Gymnasium -Includes High School size (50x84) main court and 2 cross courts (40'x60') * -No Seating
*includes 9 badminton courts TOTAL GFA 16,280 S.F	*includes 4 badminton courts TOTAL GFA 10,000 S.F



Program Highlights

FITNESS

East Markham CC+L	Centennial CC Comparison*
<ul style="list-style-type: none"> -General Fitness Area (6,500 s.f.) -Aerobics Room (1,300 s.f.) -Running Track -Men's and Women's Change Rooms -Health Service Area 	<ul style="list-style-type: none"> -General Fitness (4,000 s.f.) -Aerobics Room (1,500 s.f.) -No Running Track -Men's and Women's Change Rooms (3,150 s.f.)
TOTAL GFA 17,370 S.F	TOTAL GFA 9,515 S.F
	* Angus Glen does not include fitness centre



Fitness Areas at comparable facilities range from 4000 to 12000 s.f.

▪UTM Recreation + Wellness	12,000 s.f.
▪Oakville YMCA	9,000 s.f.
▪Brampton Cassie Campbell Rec Centre	8,500 s.f.
▪Peterborough Sport + Wellness	6,000 s.f.
▪Caledon Sport + Wellness	4,500 s.f.
▪Markham Centennial Centre	4,000 s.f.
▪Markham YMCA Conditioning Centre	6,000 s.f.

Program Highlights

LIBRARY

East Markham CC+L	Angus Glen CC+L Comparison
<ul style="list-style-type: none">-Information Services-Computer Learning Facility-Adult Info/ Multilingual/ Multi-Media Collections-Teen Area and Children's Info Playground-Study Area/ Meeting Rooms/ Staff Areas-Medical Library	<ul style="list-style-type: none">-Same program elements, but proportionately larger-No Medical Library
TOTAL GFA 20,040+3,000 (Med Library)=23,040 S.F	TOTAL GFA 29,700 S.F



Program Highlights

MULTI-USE

East Markham CC+L	Angus Glen CC+L Comparison
<ul style="list-style-type: none">-Multi-use areas (includes retractable seating for use as Performance Space)-Kitchen-Storage Areas <p>TOTAL GFA 7,700 S.F</p>	<ul style="list-style-type: none">-Same program elements proportionately smaller-No retractable seating <p>TOTAL GFA 5,400 S.F</p>



Program Highlights

OLDER ADULTS

East Markham CC+L	Angus Glen CC+L Comparison
<ul style="list-style-type: none">-Multi-Use Area-Kitchen-Games Room	Same program elements
TOTAL GFA 2,970 S.F	TOTAL GFA 2,760 S.F



Program Highlights

YOUTH

East Markham CC+L	Angus Glen CC+L Comparison
<ul style="list-style-type: none">-Multi-Use Area/ Games Room-Program Room-T.V Lounge	Same program elements
TOTAL GFA 2,670 S.F	TOTAL GFA 2,640 S.F



Costing

General Assumptions

- Costs are construction value escalated to Dec 2008
- Class A Constructor
- Equivalent construction quality to Angus Glen Community Centre & Library
- LEED Silver target
- FF+E is excluded from costing

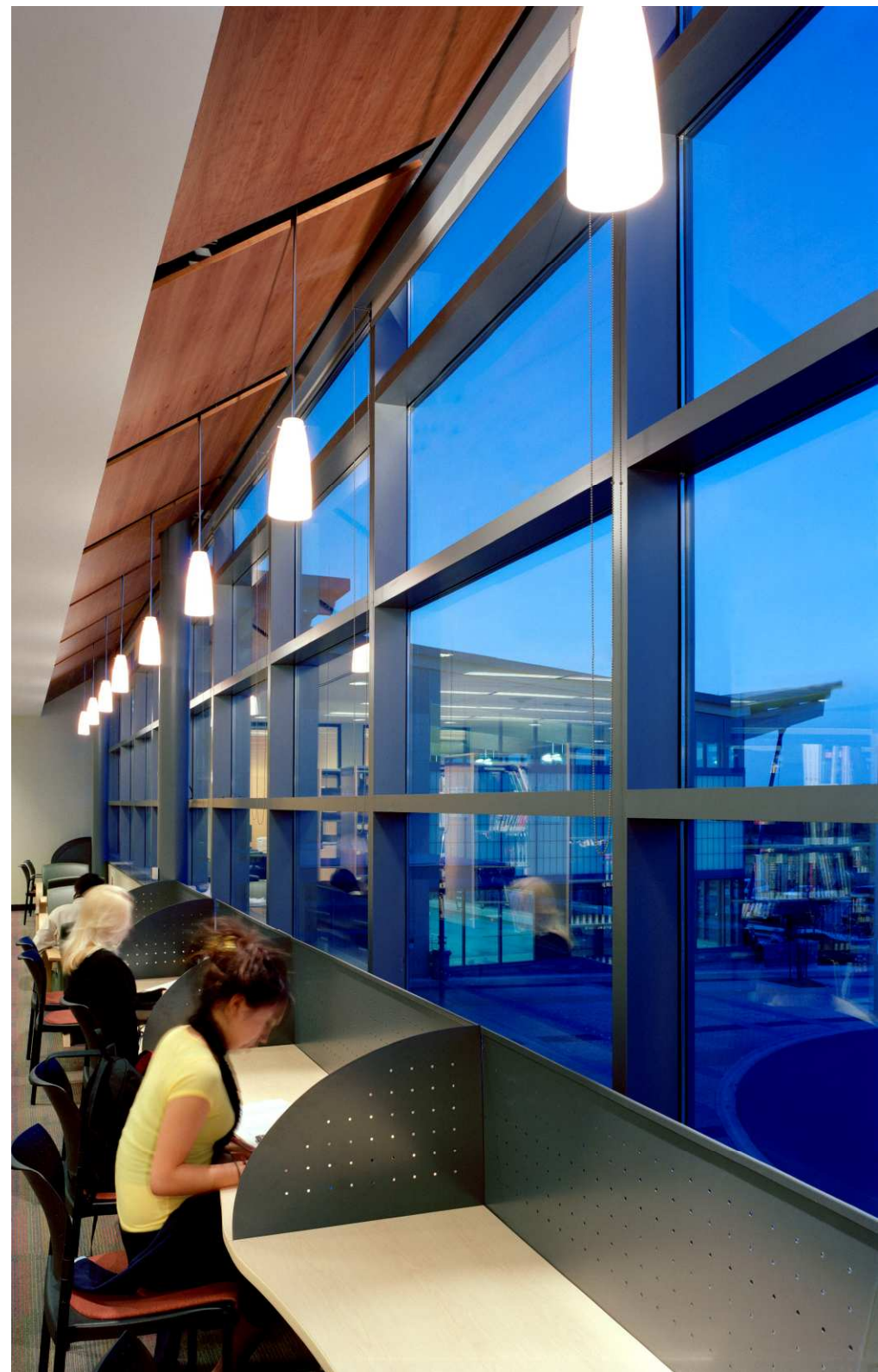

Program Overview + Costing

	Base Building Component	Area (s.f.)	Cost (\$)
A	Aquatics (includes deletion of movable bottom & bulkhead @\$474,300)	37,818 @\$327/s.f	\$11,892,186
B	Gymnasium	11,550 @\$255/s.f	\$2,945,250
C	Fitness	17,370 @\$247/s.f	\$4,290,390
D	Library	20,040 @\$283/s.f	\$5,671,320
	Medical Library	3,000 @\$283/s.f	\$849,000
E	Multi- Use	7,480 @\$246/s.f	\$1,840,080
F	Older Adults	2,970 @\$262/s.f	\$778,140
G	Youth	2,670 @\$258/s.f	\$688,860
H	Common Areas	12,900 @\$257/s.f	\$3,315,300
	Sub Total	115,798	\$32,270,526
	Public Request Items- Recommended by Staff		
J	Aquatics- Expanded Children's Play Area	3,850 @\$279/s.f	\$1,074,150
K	Gymnasium- Upgrades for Community Triple Gym	4,730 @\$249/s.f	\$1,177,770
L	Multi-Use- Upgrades for Community Performance Use	220 @\$267/s.f	\$58,740
	Sub Total	124,598	\$34,581,186
	Site Development		
	Entry Plaza, Wellness Court, Parking, Landscaping & Furnishings		\$3,229,000
	Total		\$37,810,186
	Total including Internal Cost (10%)		\$41,591,204

Total Cost Estimate & Proposed Funding Sources

COST ESTIMATE	COST (\$)
COST ESTIMATE	
Land (9.2 acres)	\$4,450,000
Parking Structure	\$7,500,000
Construction (including Internal and Construction Contingency)	\$41,590,000
FF&E / IT cost	<u>\$6,360,000</u>
Total Cost Estimate	\$59,900,000
PROPOSED FUNDING SOURCES	
90% DC Funding	\$51,617,000
10% Non DC Reserve	\$5,735,000
MSH Library Contribution for Medical Library	\$934,000
Ramp up Reserve / Tax Rate (LEED Silver/ Rec. IT)	<u>\$1,614,000</u>
Total Proposed Funding Sources	\$59,900,000



SHORE TILBE IRWIN & PARTNERS

20 Duncan St., Suite 300 Toronto, ON M5H 3G8

www.stipartners.com



SHORE
TILBE
IRWIN
&PARTNERS