

EXPLANATORY NOTE

BY-LAW 2009-163

A by-law to amend By-law 304-87, as amended

Crown of Markham Inc (Phase 1)

19TM-09003

Part Lots 23 and 24, Concession 3

LANDS AFFECTED

The By-law applies to lands located northwest of the Cathedral of The Transfiguration, east of the Woodbine By-pass and south of Betty Roman Blvd., in the West Cathedral Community.

EXISTING ZONING

The lands subject to this By-law are presently zoned Agriculture One (A1) by By-law 304-87 as amended.

PURPOSE AND EFFECT

The purpose and effect of this by-law is to remove the lands from By-law 304-87, as amended, so that they may be incorporated into By-law 177-96, as amended, to permit 16 townhouse and 3 single detached dwellings. By-law 304-87 is the Town's Rural Area By-law. By-law 177-96 is the Town's Urban Expansion Area By-law.



BY-LAW 2009-163

A by-law to amend By-law 304-87, as amended

THE COUNCIL OF THE CORPORATION OF THE TOWN OF MARKHAM
HEREBY ENACTS AS FOLLOWS:

1. By-law 304-87, as amended, be and the same is hereby further amended by deleting the lands outlined on Schedule 'A' hereto from the designated area of By-law 304-87, as amended.
2. This By-law shall not come into effect until By-law 2009-164 amending By-law 177-96, as amended, comes into effect and the lands as shown on Schedule 'A' attached hereto are incorporated into the designated area of By-law 177-96, as amended.
3. All other provisions of By-law 304-87, as amended, not inconsistent with the provisions of this by-law shall continue to apply.

READ A FIRST, SECOND, AND THIRD TIME AND PASSED THIS
10TH DAY OF NOVEMBER, 2009.

KIMBERLEY KITTERINGHAM
TOWN CLERK

FRANK SCARPITTI
MAYOR

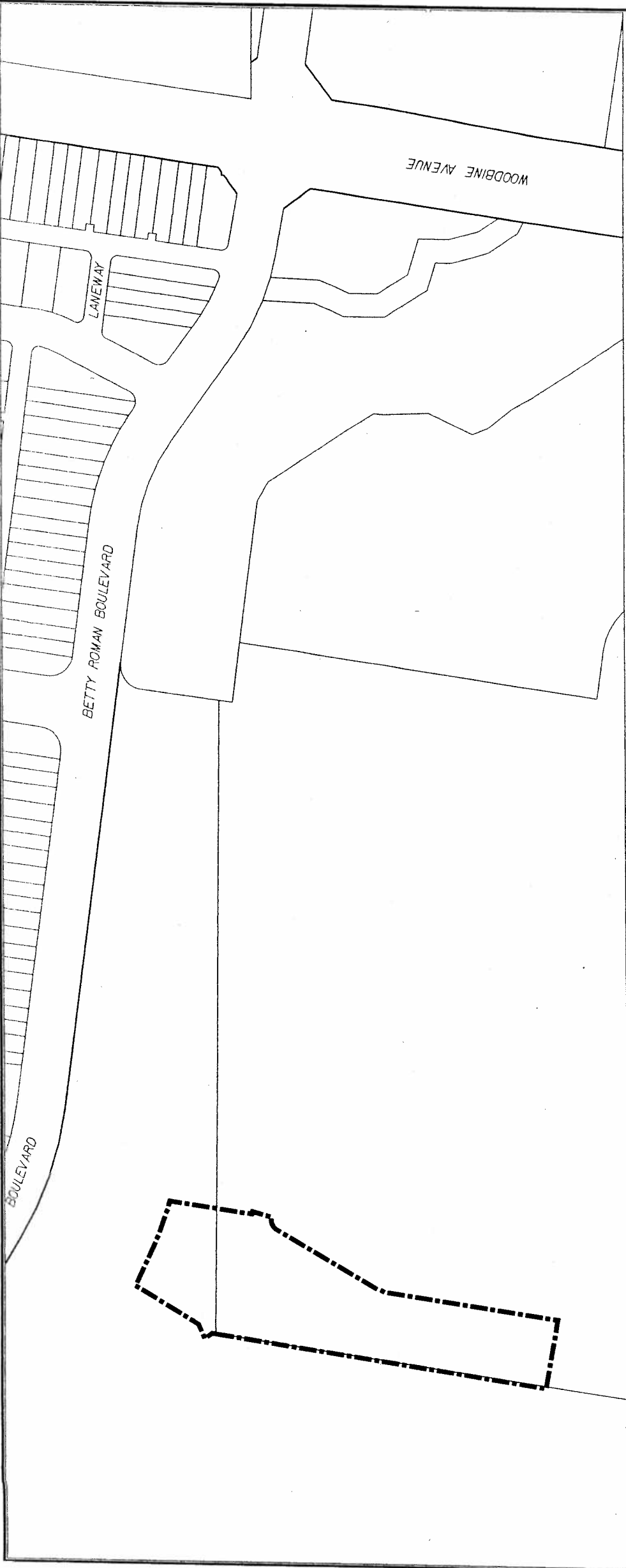

DEVELOPMENT SERVICES COMMISSION

A BY-LAW TO AMEND BY-LAW

304-87

THIS IS SCHEDULE 'A' TO BY-LAW
PASSED THIS 10TH DAY NOV., 2009

John S. Smith MAYOR

CLERK

BOUNDARY OF AREA COVERED BY THIS BY-LAW



NOTE: 1) DIMENSIONS ARE IN METRES
2) REFERENCE SHOULD BE MADE TO
THE ORIGINAL BY-LAW LODGED IN
THE OFFICE OF THE CLERK

SCALE 1: