

## **EXPLANATORY NOTE**

### **BY-LAW 2009-194**

**A By-law to amend By-law 304-87, as amended.**

**1473092 Ont. Ltd. (Metrus Developments)**

**Part of Lots 16, 17 and 18, Concession 9**

**Cornell Community**

#### **Lands Affected**

The proposed by-law amendment applies to 17.2 ha. (42.5 acres) of land located south of Donald Cousens Parkway, east of 9<sup>th</sup> Line, within the Cornell community.

#### **Existing Zoning**

The lands are presently zoned Agriculture (A1) by By-law 304-87, as amended.

#### **Purpose and Effect**

The purpose and effect of the by-law amendment is to remove the lands from By-law 304-87, as amended, so that they may be incorporated into By-law 177-96, as amended, to permit the development of 429 residential units..

---



## BY-LAW 2009-194

A by-law to amend Rural Area Zoning By-law 304-87, as amended  
(*To delete lands from the designated area of this By-law*)

---

THE COUNCIL OF THE CORPORATION OF THE TOWN OF MARKHAM  
HEREBY ENACTS AS FOLLOWS:

1. THAT By-law 304-87, as amended, is hereby further amended by deleting the lands in Lot 16, 17 and 18 Concession 9, as shown on Schedule 'A' attached hereto, from the designated area of By-law 304-87, as amended.
2. This by-law shall not come into effect until By-law 2009-195 amending By-law 177-96, as amended comes into effect and the lands, as shown on Schedule 'A' attached hereto, are incorporated into the designated area of By-law 177-96, as amended.
3. All other provisions of By-law 304-87, as amended, not inconsistent with the provisions of this by-law shall continue to apply

READ A FIRST, SECOND, AND THIRD TIME AND PASSED THIS  
15<sup>TH</sup> DAY OF DECEMBER, 2009.

  
KIMBERLEY KITTINGHAM  
TOWN CLERK

  
FRANK SCARPITTI  
MAYOR

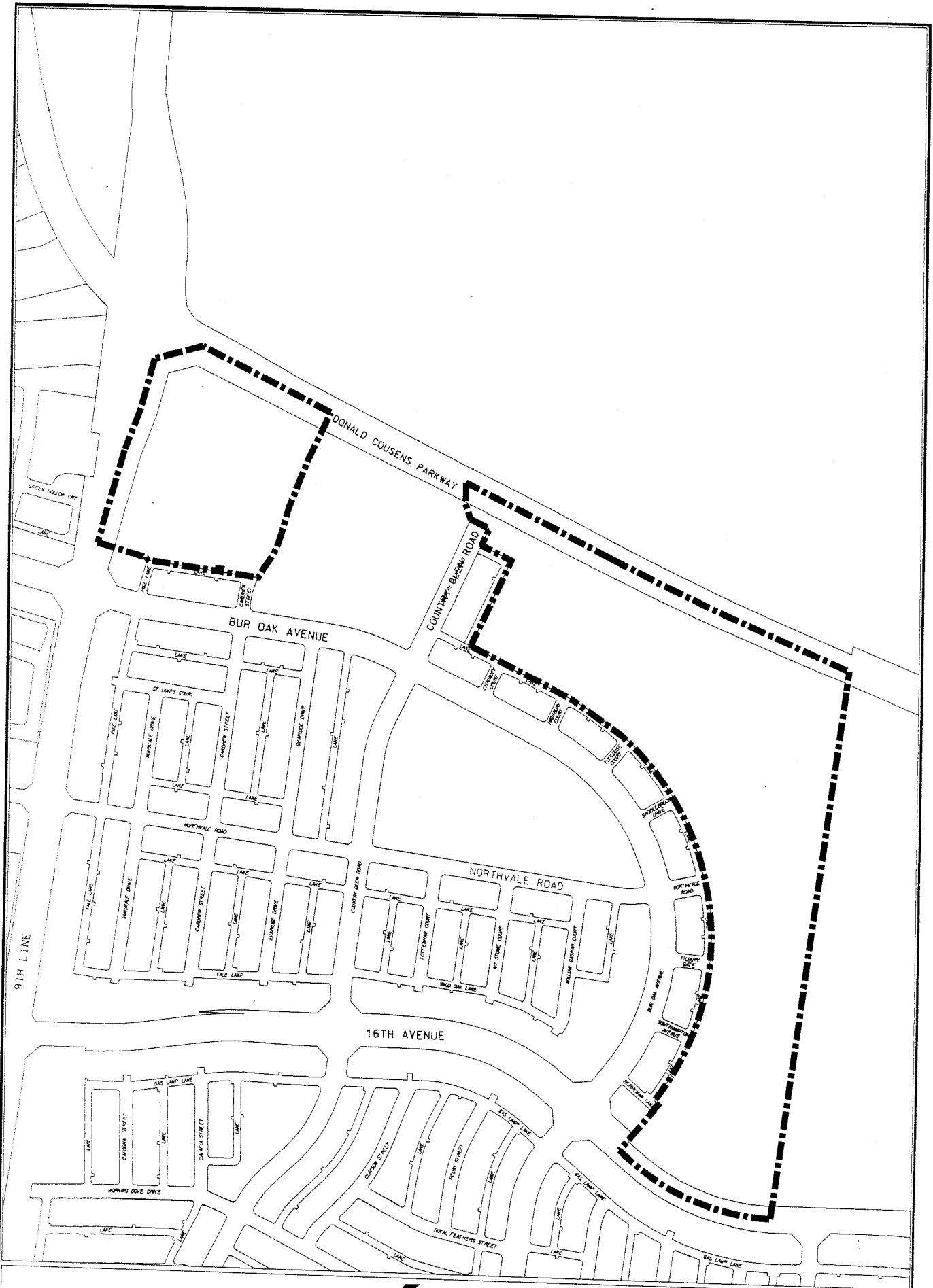

DEVELOPMENT SERVICES COMMISSION

# A BY-LAW TO AMEND BY-LAW 304-87



BOUNDARY OF AREA COVERED BY THIS BY-LAW



THIS IS SCHEDULE 'A' TO BY-LAW 2009-194  
PASSED THIS 15<sup>TH</sup> DAY DEC., 2009

*Jack Scapellato*  
MAYOR

CLERK

NOTE: 1) DIMENSIONS ARE IN METRES  
2) REFERENCE SHOULD BE MADE TO  
THE ORIGINAL BY-LAW LODGED IN  
THE OFFICE OF THE CLERK

SCALE 1: