



East Markham

Community Centre & Library

General Committee Meeting

Dec 14 2009



The Exterior Palette







The Atrium





Paul Klee 'Flora on the Sand' 1927

The Inspiration

Our Philosophy

Interior Design is a holistic layering of architectural components, interior materials, furniture, lighting and signage. These elements need to be in balance with one another to create a timeless aesthetic



The Library

Rich . Timeless . Comfortable

Strong architectural materials and details within the interior volumes require a restrained interior colour palette. Colour is used selectively to provide way finding or to animate a space.

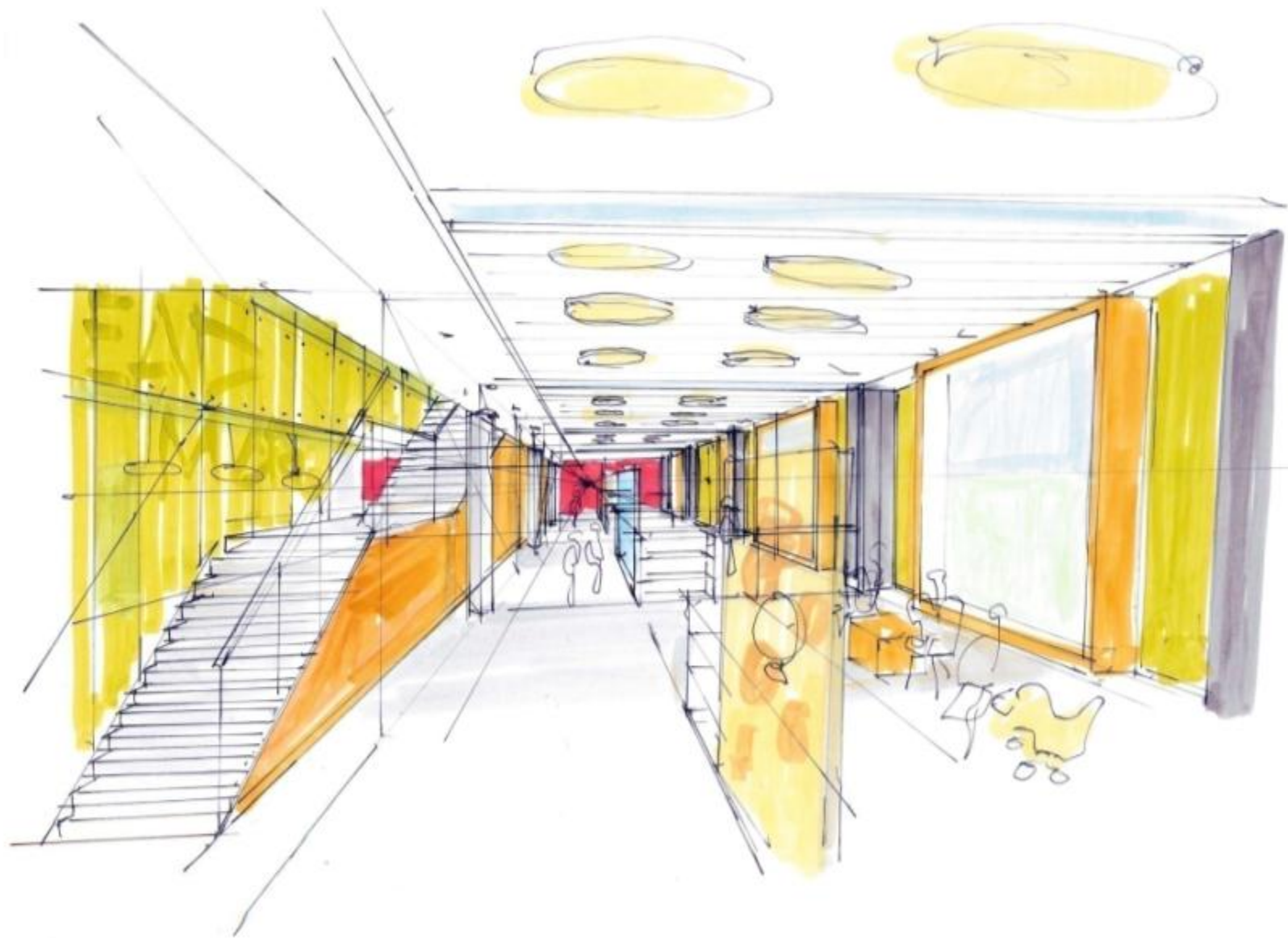

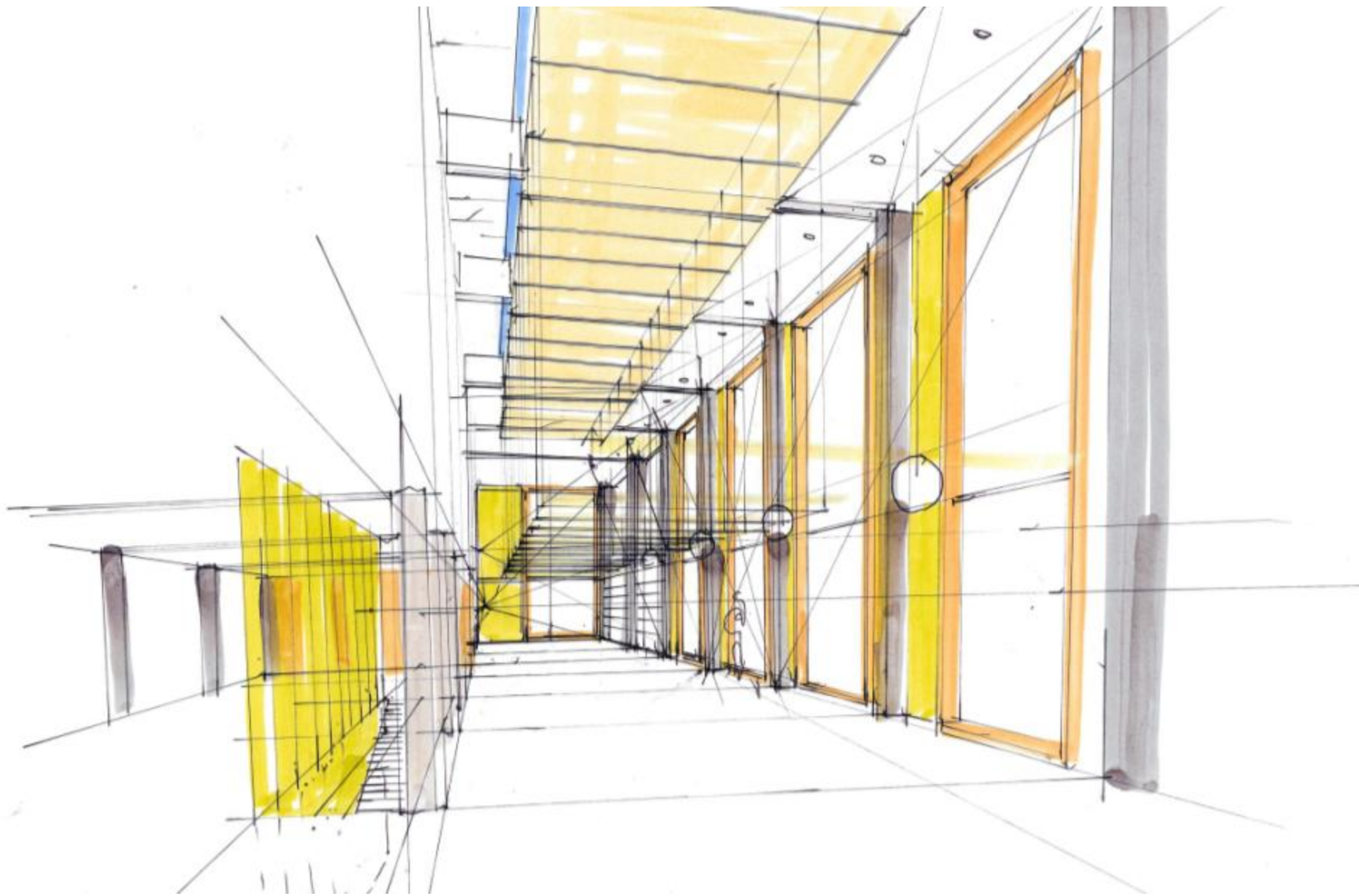

TEEN AREA

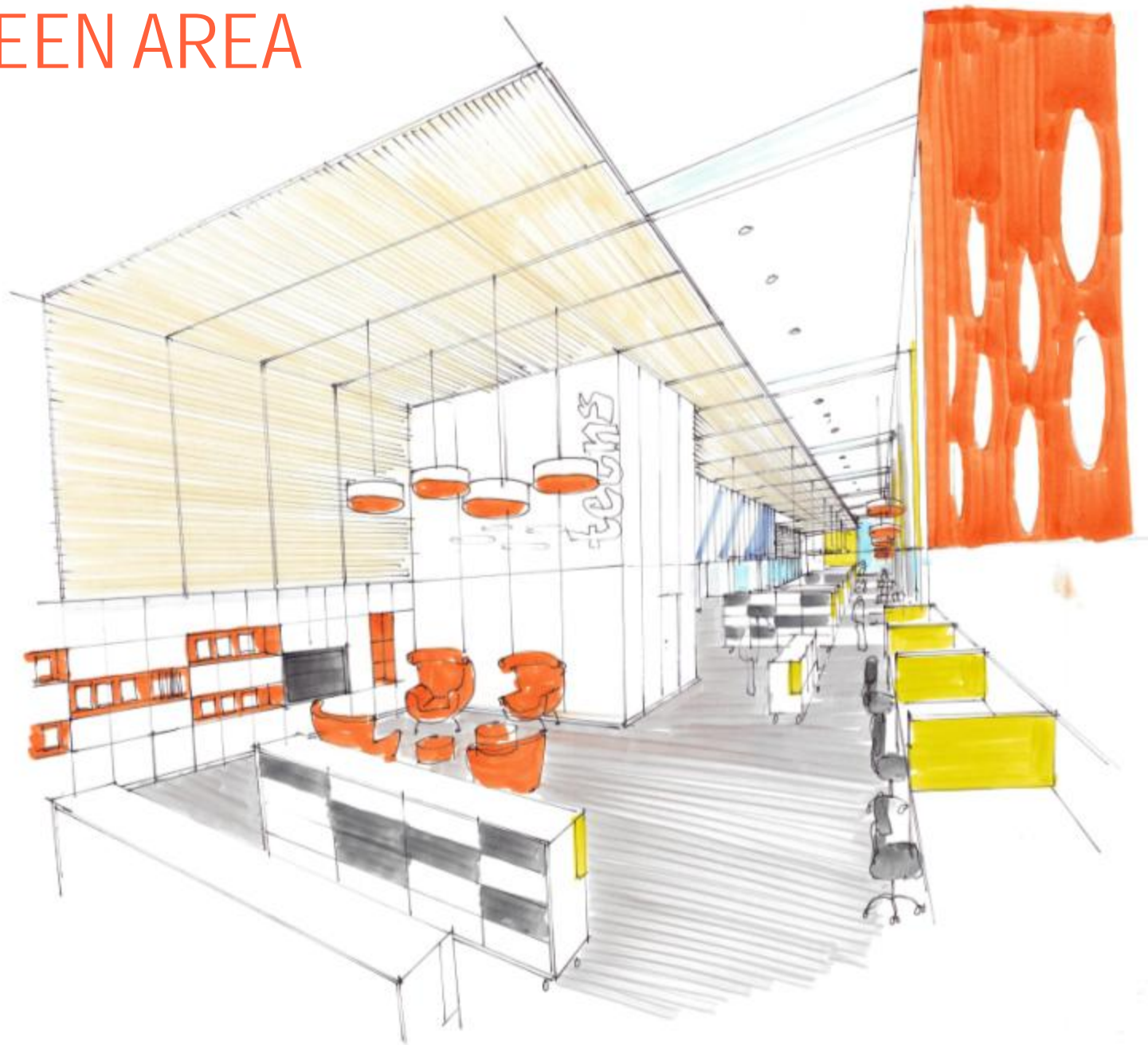

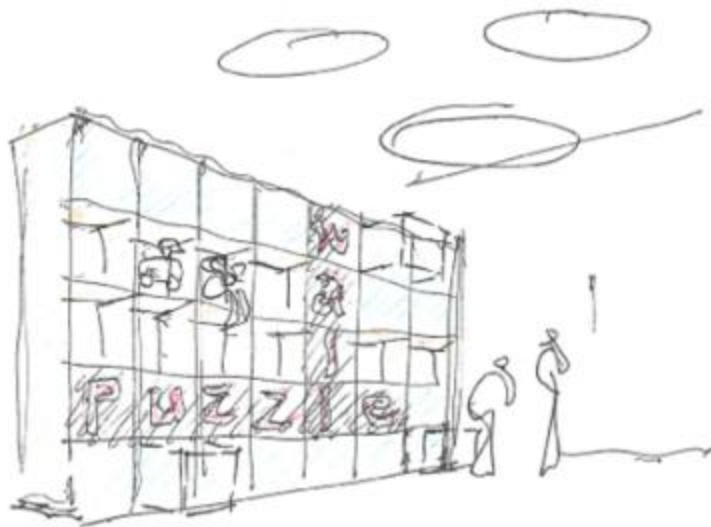

puzzle wall

The Library

The Childrens Area

Playfull . Interactive. Inspirational

KID'S DISCOVERY AREA

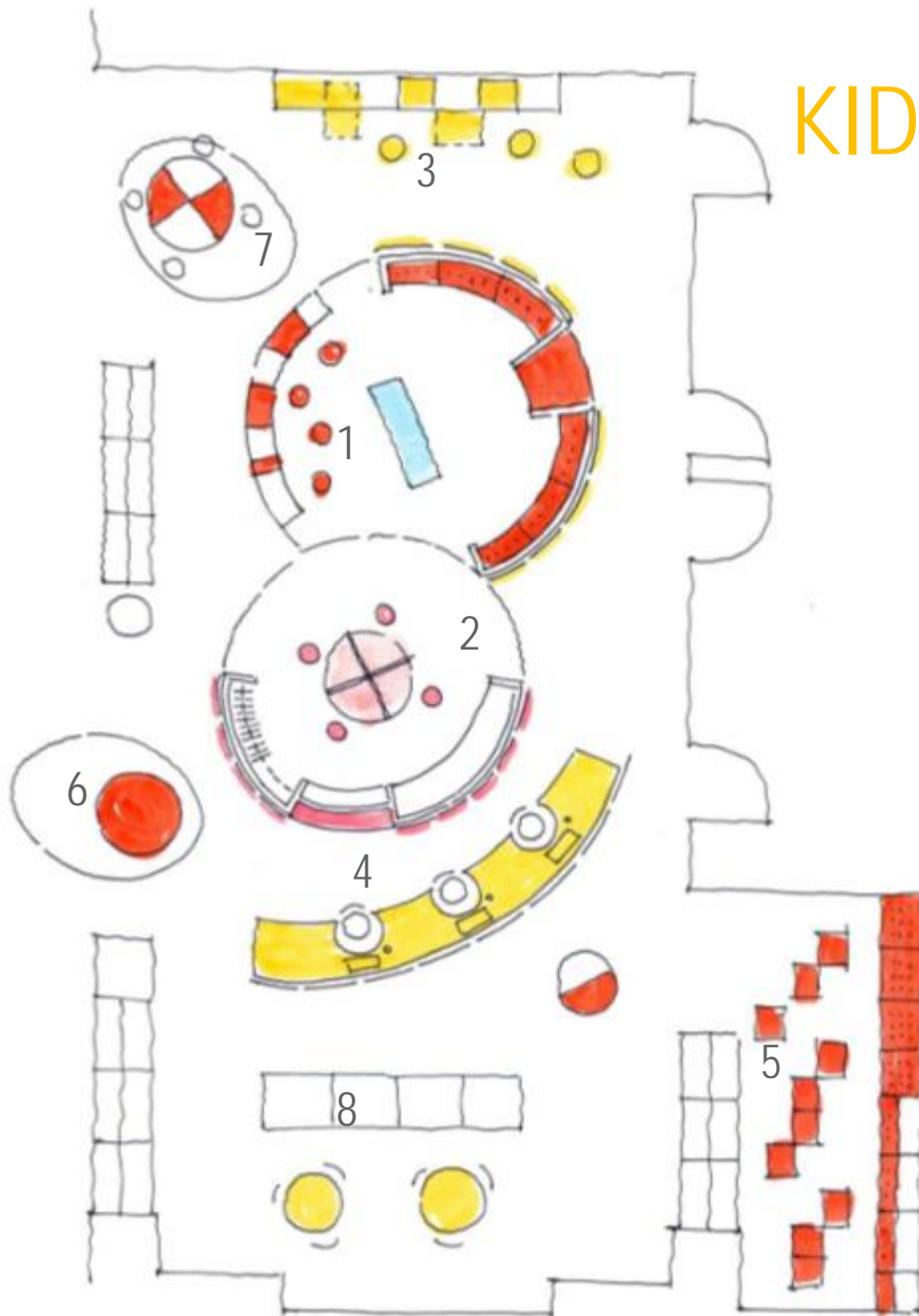

- 1 'The Space Ship'
 - the worm hole
 - the story zone
 - the control panel
 - the slide portal
- 2 'Fairytale Castle'
 - dress up table
 - costume wardrobe
 - craft + reading counter
- 3 Puzzle Wall
- 4 The Digital Playground
- 5 The Pillow Room
- 6 Coaster
- 7 Craft Kiosk
- 8 Easy Readers

KID'S DISCOVERY AREA

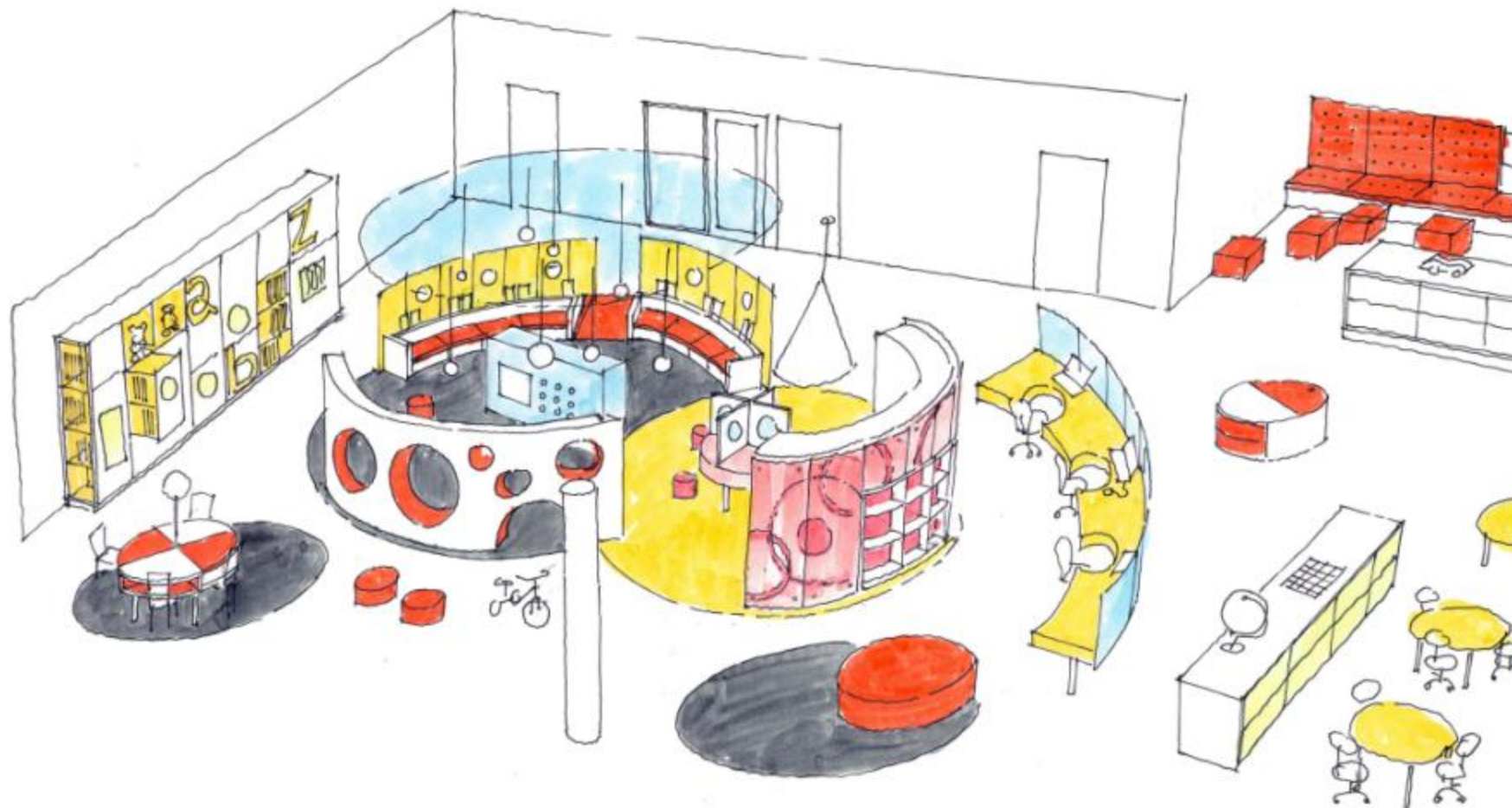

KID'S DISCOVERY AREA

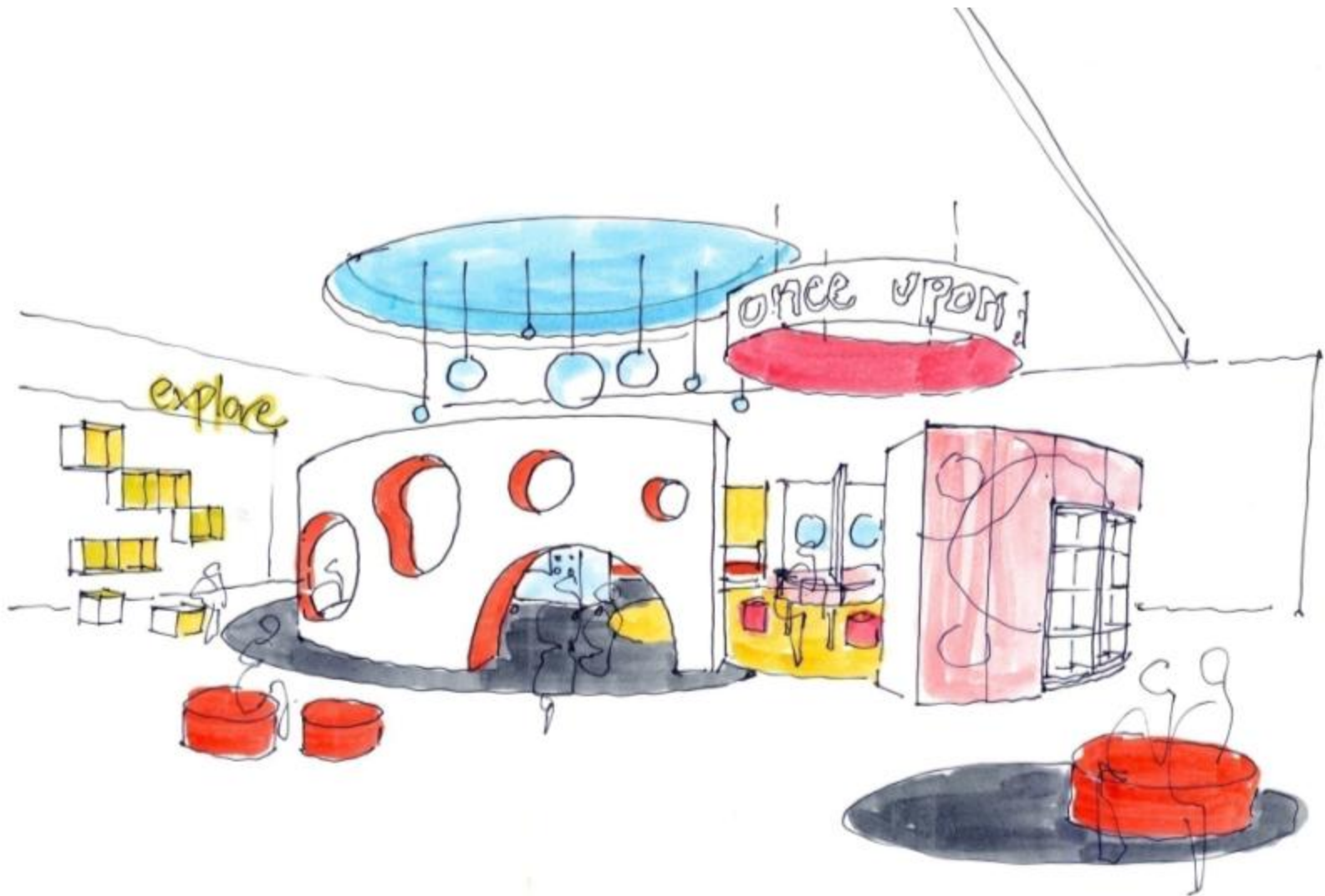

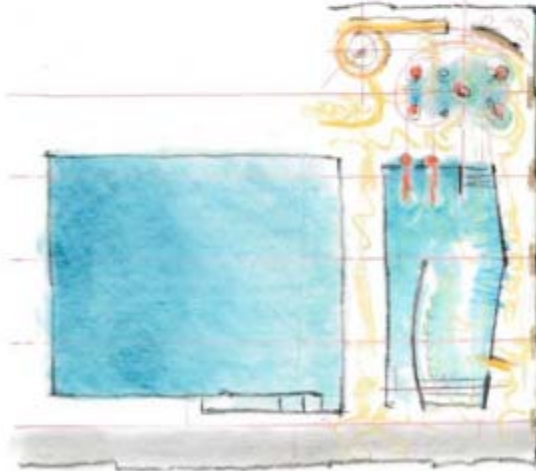

The Pool

Rejuvenate . Play. Relax . Heal

A clean white palette of tile and glass accented with bright splashes of colour focuses attention on the activities within the space and the water itself. The space is at once invigorating and calming.

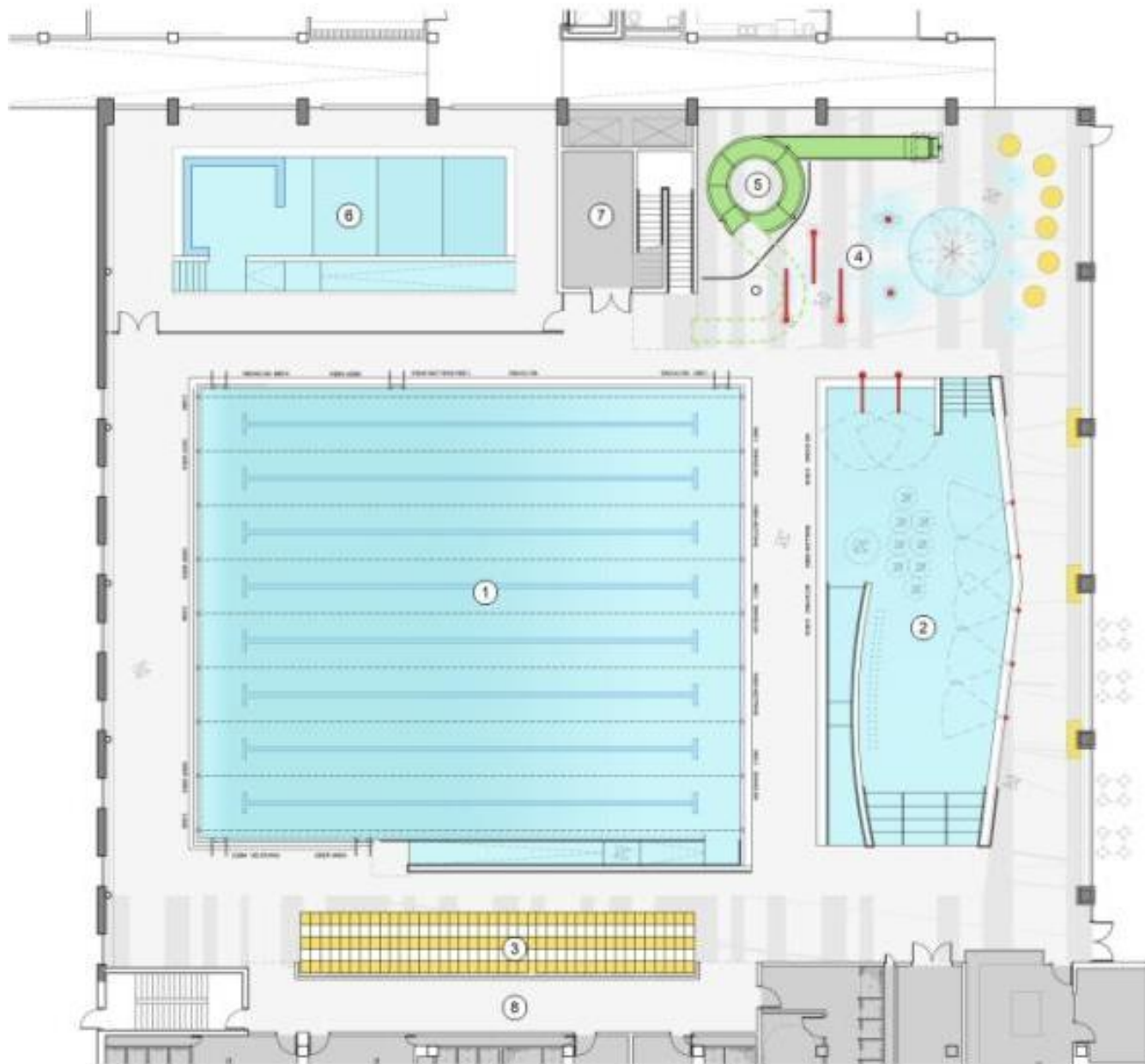



The Multi-Use Space

Comfortable . Flexible . Durable



The Rehearsal Hall

Clad entirely in wood, this space offers a warm and intimate venue for the community. Arrhythmic pattern of vertical wood slats and solid panels reinforces the musical theme of this space.





Fitness Zones

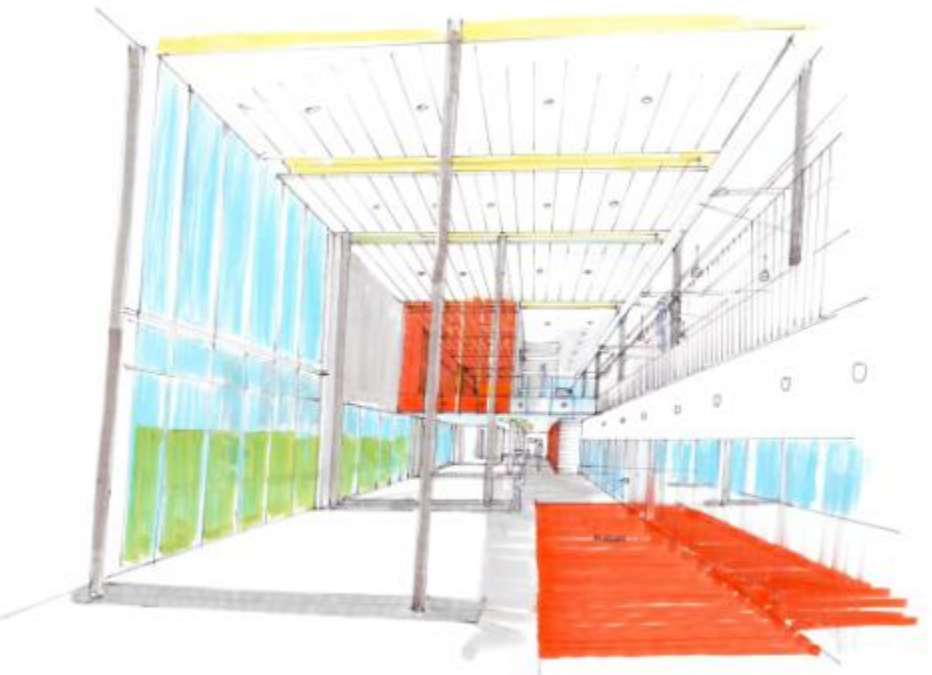



The Graphics

Signage can be both functional and artful. It is a utilitarian element within the facility that can be graphically utilized to create another layer of visual interest.



Furniture

Furniture is not an afterthought. In selecting the interior materials we need to be mindful of the affect of furniture within that space. Depending on the function of that space the furniture can be the colour within that space or we can treat it as part of the architecture and downplay it.





PUBLIC ART

Oakville Family Y
Artist: Naoko Matsubura
Medium: Acrylic on Woodcut- 9'x12'

site plan

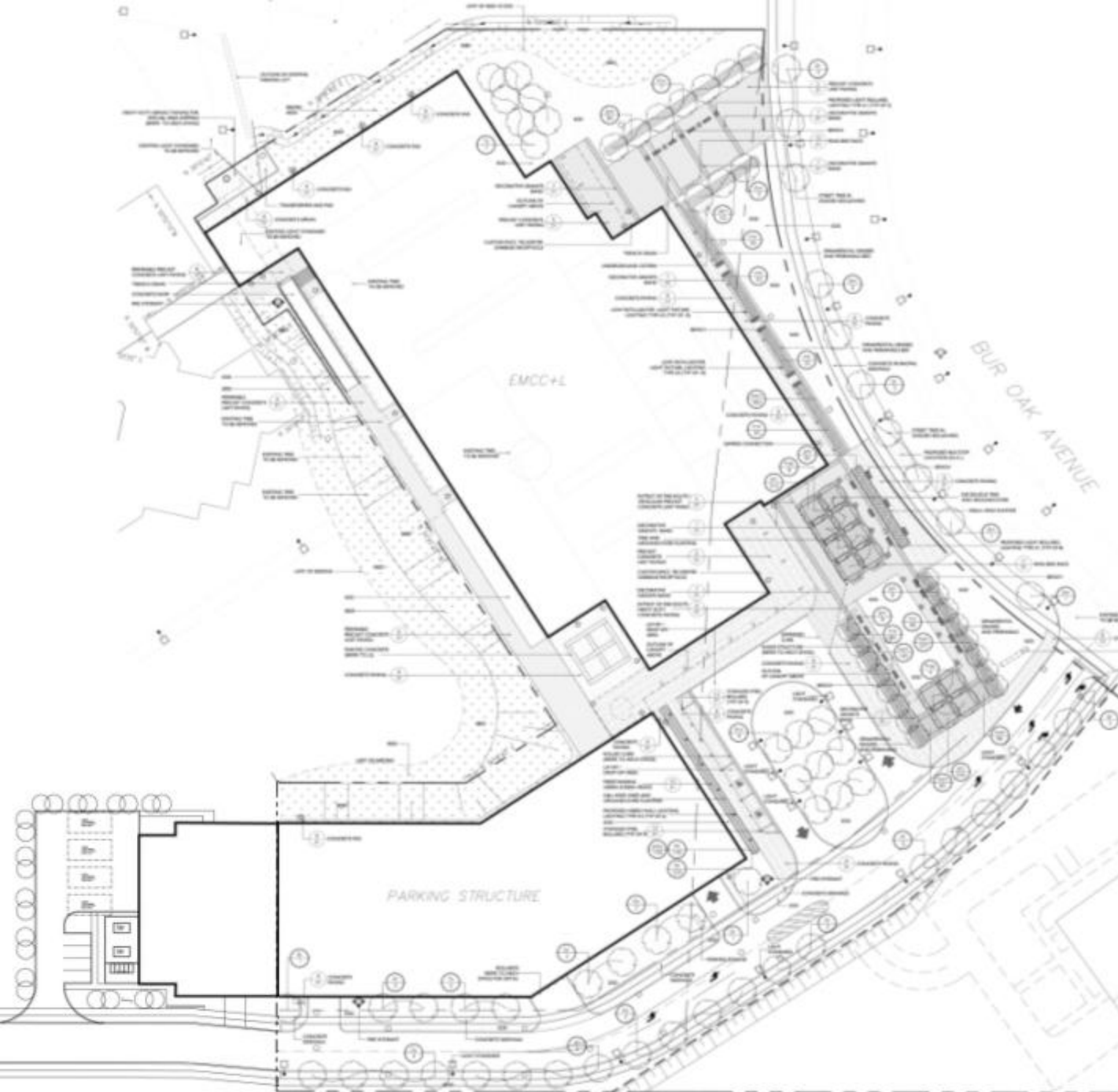



MDE Plant- aerial view from southwest



Parking Garage- aerial view from southeast



East Markham

Community Centre & Library