



AIR PHOTO 2009

APPLICANT: MOUNT JOY GO STATION
1801 BUR OAK AVENUE

FILE No: SD10110660(TK)



DEVELOPMENT SERVICES COMMISSION

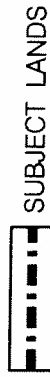

SUBJECT LANDS

DATE: 03/17/10

DRAWN BY: DD CHECKED BY: TK SCALE: 1"

FIGURE No.1



FIGURE No. 1.25

SPECIFIC SITE AND AREA POLICIES

TOWN OF MARKHAM OFFICIAL PLAN (Revised 1987) AS AMENDED

- | | | |
|---|---|--|
| Land Use designation: COMMERCIAL | Boundary of area subject to the policies in Section 4.3.12 y) i) Major Commercial Area (Heritage) | Boundary of area subject to the policies in Section 4.3.12 y) k) Major Commercial Area (Intensification and Future High Density Residential) |
| Boundary of area subject to the policies in Section 4.3.12 y) ii) Community Amenity Area (Transition and Intensification) | Boundary of area subject to the policies in Section 4.3.12 y) ii) Major Commercial Area (Avenue) | Boundary of area subject to the policies in Section 4.3.12 y) v) Major Commercial Area (Commercial and Industrial) |
| Boundary of area subject to the policies in Section 4.3.12 y) iii) Community Amenity Area (Avenue) | | |

OFFICIAL PLAN AMENDMENT No. XXX

PLANNING DISTRICT No.1

SCHEDULE FROM DRAFT OFFICIAL PLAN AMENDMENT FOR MARKHAM ROAD

APPLICANT: MOUNT JOY GO STATION
1801 BUR OAK AVENUE

FILE No: SD10110660(TK)

DATE: 03/24/10



DEVELOPMENT SERVICES COMMISSION

DWN BY: DD

CHK BY: TK

SCALE 1:

FIGURE No.2



20 Bay Street • Suite 600
Toronto, Ontario, Canada M5J 2W3
20 rue Bay, bureau 600
Toronto (Ontario) Canada M5J 2W3

Phone: 416-869-3600 ext. 5616

Fax: 416-869-1563

Email: Alan.Dick@gotransit.com

January 25, 2010

Ms. Valerie Shuttleworth
Director, Planning and Urban Design
The Town of Markham
101 Town Centre Blvd.
Markham, Ontario
L3R 9W3



Dear Ms. Shuttleworth

Subject: Project Notice
Mount Joy GO Station – West Parking Lot Expansion

Metrolinx is initiating a capital project to expand the parking facilities at the existing west lot of the Mount Joy GO Station to improve services to the surrounding communities. The proposed work will involve the development of approximately 400 parking spaces on the 5 acre parcel of land at 9577 Highway 48, Markham, which is directly south of the existing GO Station west parking lot. This land is presently owned by GO Transit and leased to the Assinck Bros. manufacturing firm. The development work of the new lot will include the demolition of the 2450 m² Assinck Bros. industrial buildings, site remediation, asphalt paving, landscaping to complement the surrounding neighbourhood, new site services including storm water management, area lighting, pedestrian walkways, concrete curbs, signage and fencing. We are also proposing to add a new entrance / exit from Highway 48 to the new parking lot.

This is to advise you of this Metrolinx initiative and to determine whether there are any immediate concerns pertaining to the proposal under consideration. Attached is an overview of the proposed undertaking for your information.

We encourage you to advise Metrolinx of any concerns or information that you may have in connection with this project. Your prompt response will assist us in identifying key issues at the early stage in the design process. If you have no comments at this time, we would appreciate, nevertheless, an indication of your interest in remaining on the project mailing list. Please indicate your interest by completing the attached form and return, by March 1, 2010, a copy for our records.

As you are aware, Metrolinx, as a Provincial Crown Agency, is not subject to the Ontario *Municipal Act*, the *Planning Act* or the *Development Charges Act*. However, it is Metrolinx's policy that when service improvements and infrastructure are being developed, they are done in partnership with local municipalities. When developing plans for new or expanded facilities,

Metrolinx keeps the affected municipalities informed of the progress and cooperates with municipal staff to ensure facilities constructed meet municipal requirements to the greatest extent possible.

For the proposed west parking lot expansion at the Mount Joy GO Station, Metrolinx will not be seeking site plan approval and will not enter into a site plan agreement with the Town. However, as with Metrolinx projects performed in the past, we will work closely with Town staff to incorporate your comments where possible.

If you require further information about this project or related background information, please contact the undersigned. We look forward to an early response from your office. The firm of R.J. Burnside & Associates Limited has been retained by Metrolinx as the primary design consultant for this project.

Sincerely,

A handwritten signature in black ink, appearing to read 'Alan Dick', with a stylized flourish at the end.

Alan Dick, P. Eng.
Project Coordinator

Attachment

cc: Mr. Dave Kesler, Project Manager, R.J. Burnside & Associates Limited
Ms. Karen Lauder, Manager, Station Operations East
Mr. Nick Spensieri, Manager, Parking Infrastructure
Mr. Hubert Kloda, Senior Project Officer
Ms. Trina Melatti, Communication Specialist, Infrastructure Projects

**MOUNT JOY GO STATION
WEST PARKING LOT EXPANSION
INFORMATION PACKAGE**

Attachment "A" - Project Overview

Attachment "B" - Key Plan

Attachment "C" - Expression of Interest Form

JANUARY 2010

ATTACHMENT "A" - PROJECT OVERVIEW

MOUNT JOY GO STATION, WEST PARKING LOT EXPANSION

1.0 Project Name

Mount Joy GO Station – West Parking Lot Expansion.

2.0 Project Purpose and Justification

The demand for parking at the Mount Joy GO Station is greater than the current supply of 807 spaces. GO Transit is planning on facilitating this parking expansion to meet the demand by constructing a new parking lot on the recently acquired land south of the GO Station at 9577 Highway 48, Markham.

3.0 Proposed Work

The proposed expansion work includes asphalt paving, landscaping to complement the surrounding community, new site services including storm water management, area lighting, new pedestrian walkways, concrete curbs, signage and fencing.

4.0 Class EA Process

Class A Project:

Work under this project is associated with the improvement of GO Transit's facility which impacts on day-to-day operations and conditions which would affect GO Transit's ability to maintain a given level of service. In accordance with GO Transit's Class EA Document, dated December 2003 (as amended August 2005), this project is categorized as a Group "A" undertaking and is therefore deemed approved.

5.0 Site Map

The attached plan shows the location of the proposed undertaking.

6.0 Planned Schedule

Complete Detailed Design
Tender
Construction Period

May 14, 2010
May 2010 – July 2010
October 2010 – August 2011

MOUNT JOY GO STATION, WEST PARKING LOT EXPANSION

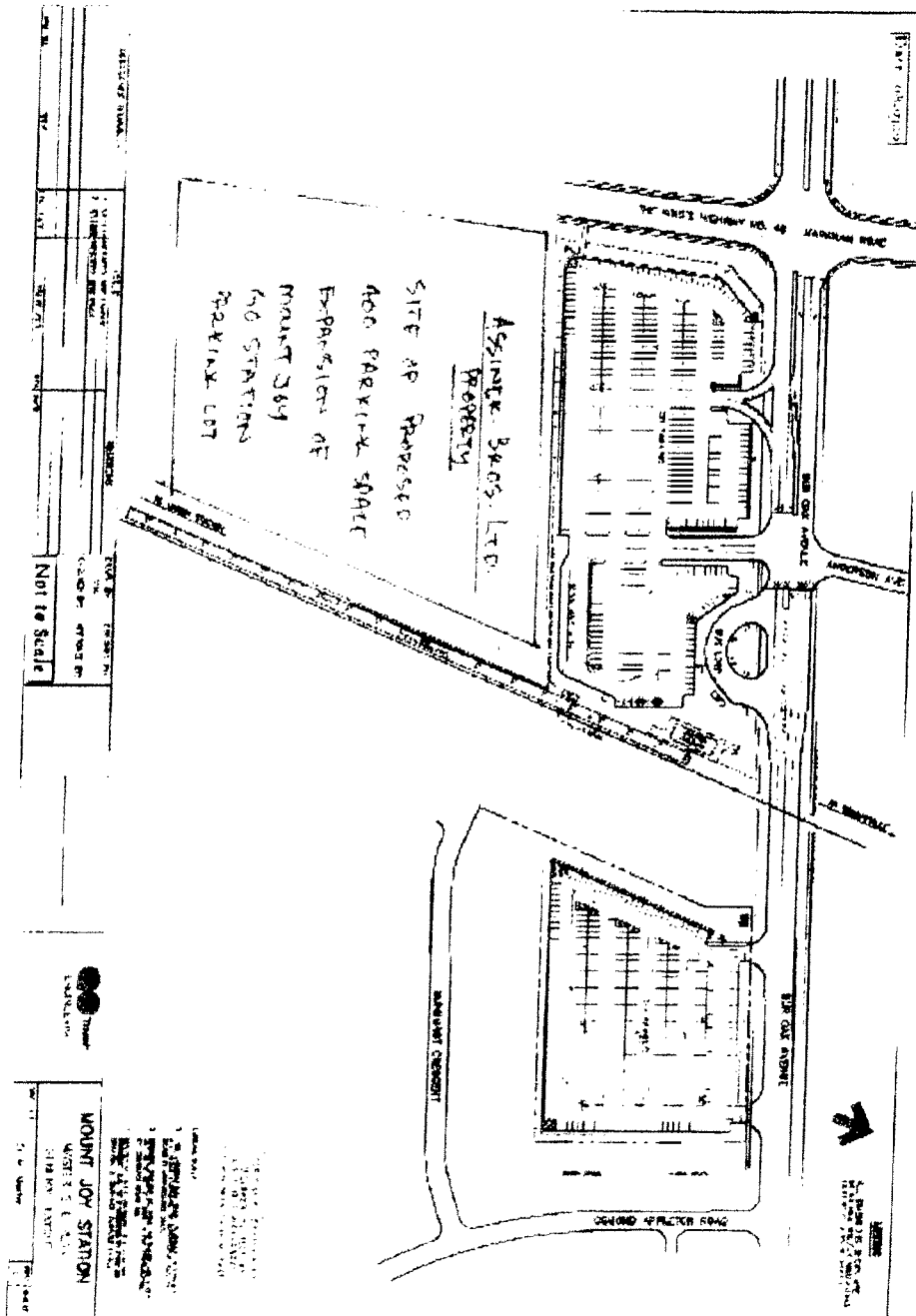

NOTING

ALL DIMENSIONS SHOWN ARE
IN METERS AND/OR MILLIMETERS
UNLESS OTHERWISE NOTED

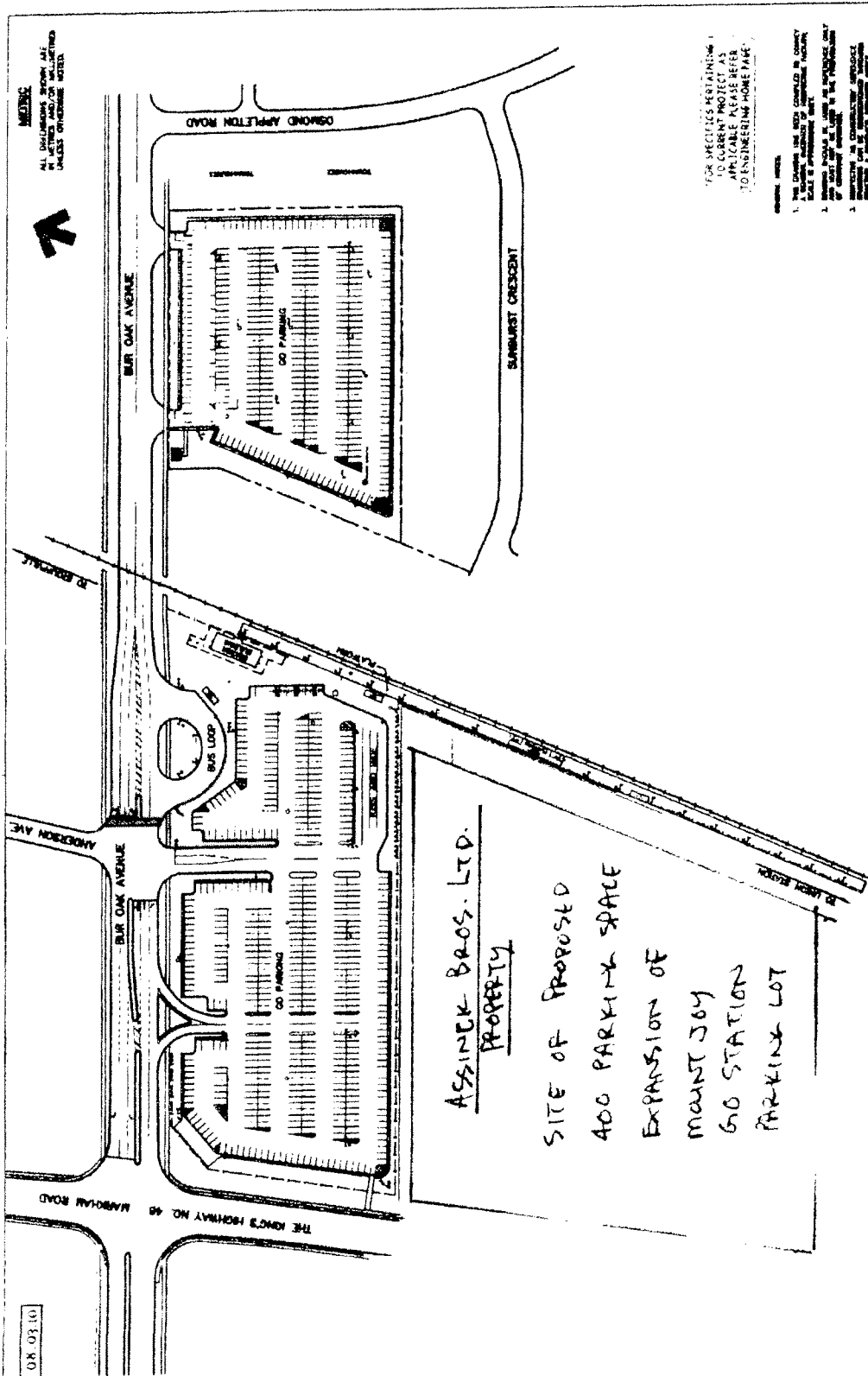

FOR SPECIFICS PERTAINING TO
CURRENT PROJECT AS
APPLICABLE PLEASE REFER
TO ENGINEERING HOME PAGE.

1. THE DANGER HAS BEEN CONTROLLED IN COUNTY BY THE EXERCISE OF EXTENSIVE POLICE PATROLS AND A STATIONED UNIT.
2. BOMBING RESULTS IN LOSS OF LIVES ONLY AND NOT IN LOSS OF LIFE IN THE PROTECTION OF COUNTRY SERVICE.
3. REPORTING ON COMBINATION SERVICE BOMBING CAN BE ACCURATELY REPORTED BY THE BOMBING SERVICE.

MOUNT JOY STATION
MASTER SITE PLAN
GENERAL LAYOUT

THE AMERICAN SOCIETY OF MECHANICAL ENGINEERS

1. NAME (PRINT) : BARBARA L. BARNES 2. ADDRESS (PRINT) : 1000 N. 2ND AVE. ST. LOUIS, MO. 63103 3. PHONE (AREA CODE AND NUMBER) : 314-241-1721

Not to Scale

POSITIVE

ISUE

REFERENCE DRAMAS

BY UPDATED SITE LAYOUT
BY UPDATED SITE PLAN

4	04.10.2018	04.10.2018
5	05.10.2018	05.10.2018

--	--

100

1000

Figure 1

+

1	2	3	4	5	6	7	8	9	10	11	12	13	14	15	16	17	18	19	20	21	22	23	24	25	26	27	28	29	30	31	32	33	34	35	36	37	38	39	40	41	42	43	44	45	46	47	48	49	50	51	52	53	54	55	56	57	58	59	60	61	62	63	64	65	66	67	68	69	70	71	72	73	74	75	76	77	78	79	80	81	82	83	84	85	86	87	88	89	90	91	92	93	94	95	96	97	98	99	100
---	---	---	---	---	---	---	---	---	----	----	----	----	----	----	----	----	----	----	----	----	----	----	----	----	----	----	----	----	----	----	----	----	----	----	----	----	----	----	----	----	----	----	----	----	----	----	----	----	----	----	----	----	----	----	----	----	----	----	----	----	----	----	----	----	----	----	----	----	----	----	----	----	----	----	----	----	----	----	----	----	----	----	----	----	----	----	----	----	----	----	----	----	----	----	----	----	----	----	-----

--	--

© 2000 Blackwell Science Ltd

[illegible]

...the ...

[illegible][illegible]

1. *Staphylococcus aureus* (S. aureus)

100

Abstract

Figure 1

© 2000 Blackwell Science Ltd

REVISED FOR

DATE _____

--	--

Abstract

THE

[View all posts by](#) [Pamela Wilson](#)

7

**ATTACHMENT "C" - EXPRESSION OF INTEREST
MOUNT JOY GO STATION, WEST PARKING LOT EXPANSION**

PLEASE RETURN BY MARCH 1, 2010

**Alan Dick , Project Coordinator
GO Transit
Suite 600 – 20 Bay Street
Toronto ON M5J 2W3**

**Phone: 416-869-3600, Ext. 5616
Fax: 416-869-1563
E-mail: Alan.Dick@gotransit.com**

Please check the appropriate box:

- ☐ We wish to be kept informed and would like to remain on the project mailing list. We have comments to provide and they are attached.
- ☐ We wish to be kept informed and would like to remain on the project mailing list. At the present time, we have no significant concerns/comments to provide.
- ☐ We have no significant concerns regarding the above-noted study. Please remove our name from the project mailing list.

Name: _____
(Please print)

Phone No: _____

Agency: _____

Signed: _____

Date: _____