



COMMUNITY EVENT – WORK ORDER

ROAD USE NOTIFICATION

Event Name: 42nd Annual Markham Santa Claus Parade

Event Date: November 29th, 2014 11:30am – 1:30pm

Organizer: Rotary Club of Markham

ORGANIZATION INFORMATION

Title: Co-Chairs

Name: Jim Sandiford

Host Organization: Rotary Club of Markham

Address: 45 Sheppard Ave East, Suite 703

City, Prov.: Markham, Ontario

Postal Code: M2N 5W9

Email: jim.sandiford@dntw.com

Cell Tel: 416-729-4377

Fax: 416-229-2583

Name: Dennis Flaherty

Host Organization: City of Markham

Address: 101 Town Centre Blvd.

City, Prov.: Markham, Ontario

Postal Code: L9R9W3

Email: dflaherty@markham.ca

Tel: 905-477-7000 ext. 7520

Fax: 905-475-4741

ROAD USE CONTACT INFORMATION

Event Organizer Name: Jim Sandiford

Daytime Number: 416-729-4377

Name on Event Day (on-site): John Vipond

Cell Number: 416-892-390

ROADS INVOLVED

List the street(s) and/or roads affected and proposed closures from start to finish route.

Road Use/ Closure Time / Date / Location:

1. Nov 29th @ 8.00am – 1.30pm – Starting at Hwy 7/Main Street Markham East up to Wooten Way
2. Nov 29th @ 9.00am – 1.30pm – Hwy 7 North of Main Street North up to Parkway Avenue/Bullock Drive

Road Use/Closure Start Date: Saturday, November 29th, 2014

Road Use/Closure End Date: Saturday, November 29, 2014

Road Use/Closure Set-up Time(s): 7:00 am/8:00 am/9:00am/10:00 am

Road Use/ Closure Tear Down Time(s): 1:30 pm

Event Location: Main St. Markham North, November 29 @11:30am – 1:30pm

This event will be contained to the road closure/sidewalks on the following roads:

Road Closure on November 29th, 2014 @ 7:00 am – 9:00 am – 1:30pm

- | | | |
|----|---|------------------|
| 1. | Hwy 7 North of Main St. North Markham Parkway Ave. -November 29, 2014 | 9:00 am – 1:30pm |
| 2. | Hwy 7 East of Wooten Way to West of Hwy 48 | 8:00 am – 1:30pm |
| 3. | Wooten Way West of Hwy 7] | 8:00 am – 1:30pm |
| 4. | Wideman St. North of Hwy 7] | 8:00 am – 1:30pm |
| 5. | Christman Court South of Hwy 7] | 8:00 am – 1:30pm |

6. Savannah Cres. North of Hwy 7]	8:00 am – 1:30pm
7. Jerman St. North of Hwy 7]-Local	8:00 am – 1:30pm
8. Thomson Court West of Main St.]	9:00 am – 1:30pm
9. Washington St. North of Hwy 7]	8:00 am – 1:30pm
10. Albert Street & Hwy 7		8:00 am - 1:30pm
11. Centre Street east of Main St.]	9:00 am – 1:30pm
12. Robinson St. West of Main St.]	9:00 am – 1:30pm
13. Albert St, North of Hwy 7]	8:00 am – 1:30pm
14. Dublin St. West of Main St.		9:00 am – 1:30pm
15. Robinson St. East of Main St Markham to George St	-Primary/Local	7:00 am – 1:30pm
16. Wilson St. West of Main St.	-Local	9:00 am – 1:30pm
17. Bullock Drive West of Main St.	-Primary/Local	9:00 am – 1:30pm
18. Parkway Ave. East of Main St.	-Primary/Local	9:00 am – 1:30pm
19. Ramona Blvd. West of George St.	local	9:00 am - 1:30pm
20. Reeves Drive	Local	9:30 am – 11:00am
21. Station St. West of Main St.	-Local	10:00 am – 1:30pm
22. Beech St. West of Main St.	-Local	10:00 am – 1:30pm
23. Eby Way West of Main St.	-Local	10:00 am – 1:30pm
24. Springdale Ave. West of Main St.	-Local	10:00 am – 1:30pm
25. Gleason Ave East of Main St.	-Local	10:00 am – 1:30pm
26. Peter St. South of 16 th Ave	-Local	10:00 am – 1:30pm
27. David St. West of Main St.	-Local	10:00 am – 1:30pm
28. Pilkey Lane East of Main St.	-Local	10:00 am – 1:30pm
29. Elizabeth St. South of 16 th Avenue	-Local	10:00 am – 1:30pm
30. Quarry Stone Ave. South of 16 th Ave.	(Local traffic only)	10:00 am – 1:30pm
31. 16 th Ave. East of Mingay Ave.	-Primary/Local	10:00 am – 1:30pm
32. Heritage Corners North of 16 th Ave.	(Local traffic only)	10: 00 am – 1:30pm
33. Main St. North-East of Deer Park Lane	-Primary/Regional	10:00 am – 1:30pm
34. Main St. North-East & West of 16 th Ave.	-Primary/Regional	10:00 am – 1:30pm
35. Main St. North; North of Bur Oak Ave.	-Primary/Regional	10:00 am – 1:30pm

Detour Route

1. From Hwy 7 travel West to Hawkridge Ave. North
2. Hawkridge Ave. North to Bullock Drive West to McCowan Ave.
3. From Major MacKenzie Drive to Roy Rainey Ave. to Castlemore Ave.
4. From 9th Line to Major MacKenzie Drive

To Markham Village Community Centre

5. From 9th Line to Hwy 7 to Wootenway South
6. Wooten Way South to Major Buttons Drive
7. Major Buttons Drive to Squire Bakers Lane
8. Squire Bakers Lane to Tuclor Lane
9. Tuclor Lane to Billy Joel Crescent
10. Billy Joel Crescent to Rougecrest Drive

ALTERNATE ROUTE

- See public notification map

EQUIPMENT REQUIREMENTS

- Please see the attached Excel document for further details regarding Barricades, “Road Closed Ahead” signage and “Road Closed” signage.

PYLONS & SAFETY VESTS

Quantity required: **Pylons: 40** **Vests: 37**

MUNICIPAL PARKING LOTS INVOLVED

Will your event use a municipal parking lot? Yes
If yes, please indicate the Parking Lot Location

Location: Arena at Hwy 7 & Hwy 48 **Time of Use:** 7:00 am – 1:30pm

Go Train Parking lots at Bullock/ Main Street & Bur Oak –Mount Joy & Markham Go Stations

PARKING / TRAFFIC & TRANSPORTATION CONTROL PLAN

Participant and Guest Parking Plan:

- Go Transit parking lots– Mount Joy & Markham Go Stations at Main Street & Bur Oak
- Participants will use existing parking lots along the parade route.

REGIONAL & PROVINCIAL ROADS

Use of regional or provincial roads: Yes Yes

APPROVAL LEVELS

- 1) Road use that is contained to City of Markham roadways requires approval from the following group(s):
 - Clerks Department
 - Road use is contained within a specified area in which there is a minimum number of homes involves
 - Council Approval
 - Main traffic is interrupted
- 2) Road Use that occurs within the right-of-way of a regional road requires:
 - York Region Transportation & Works Department Permit
- 3) Road Use that occurs within the right-of-way of a provincial road:
 - Ministry of Transportation / Road Work Scheduling & Coordination Unit

PUBLIC NOTICE

UPCOMING EVENT / ROAD CLOSURES

42ND ANNUAL MARKHAM SANTA CLAUS PARADE



Presented by:
THE ROTARY CLUBS
OF MARKHAM



Saturday, November 29 • 11 a.m. - 1 p.m.

Main Street Markham (Markham Rd. & Hwy. 7)

Parade starts at Hwy. 7 and goes north to the Markham Museum
(Free parking available)

MarkhamSantaClausParade.com



Parade Sponsors:



Media Sponsors:



ROAD CLOSURES: **NOVEMBER 29, 2014**

 Roads closed from 8:00 a.m. to 1:30 p.m.

 Roads closed from 9:00 a.m. to 1:30 p.m.

 Alternate route to access Markham Village Community Centre

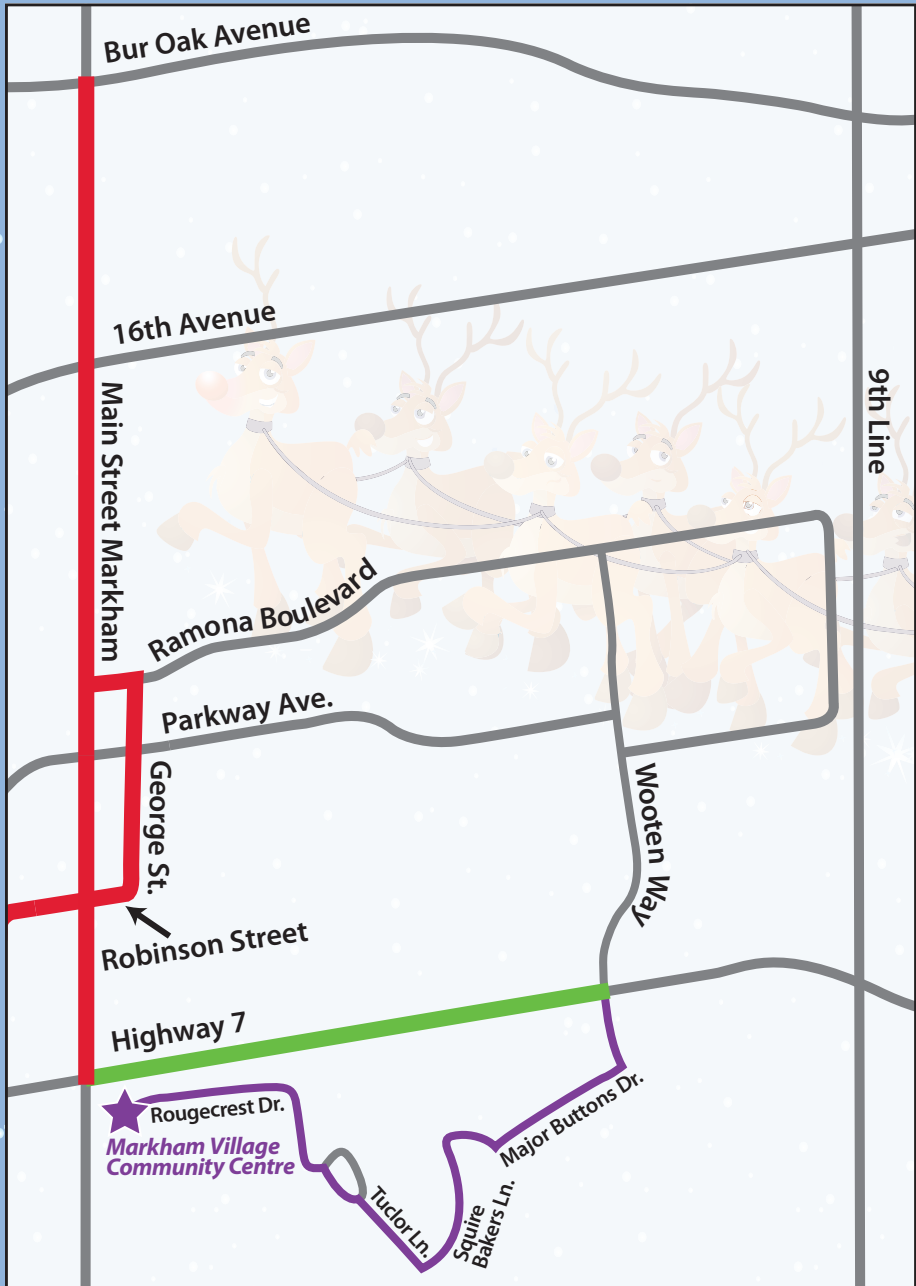

MAJOR MACKENZIE DR E

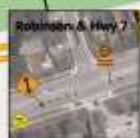
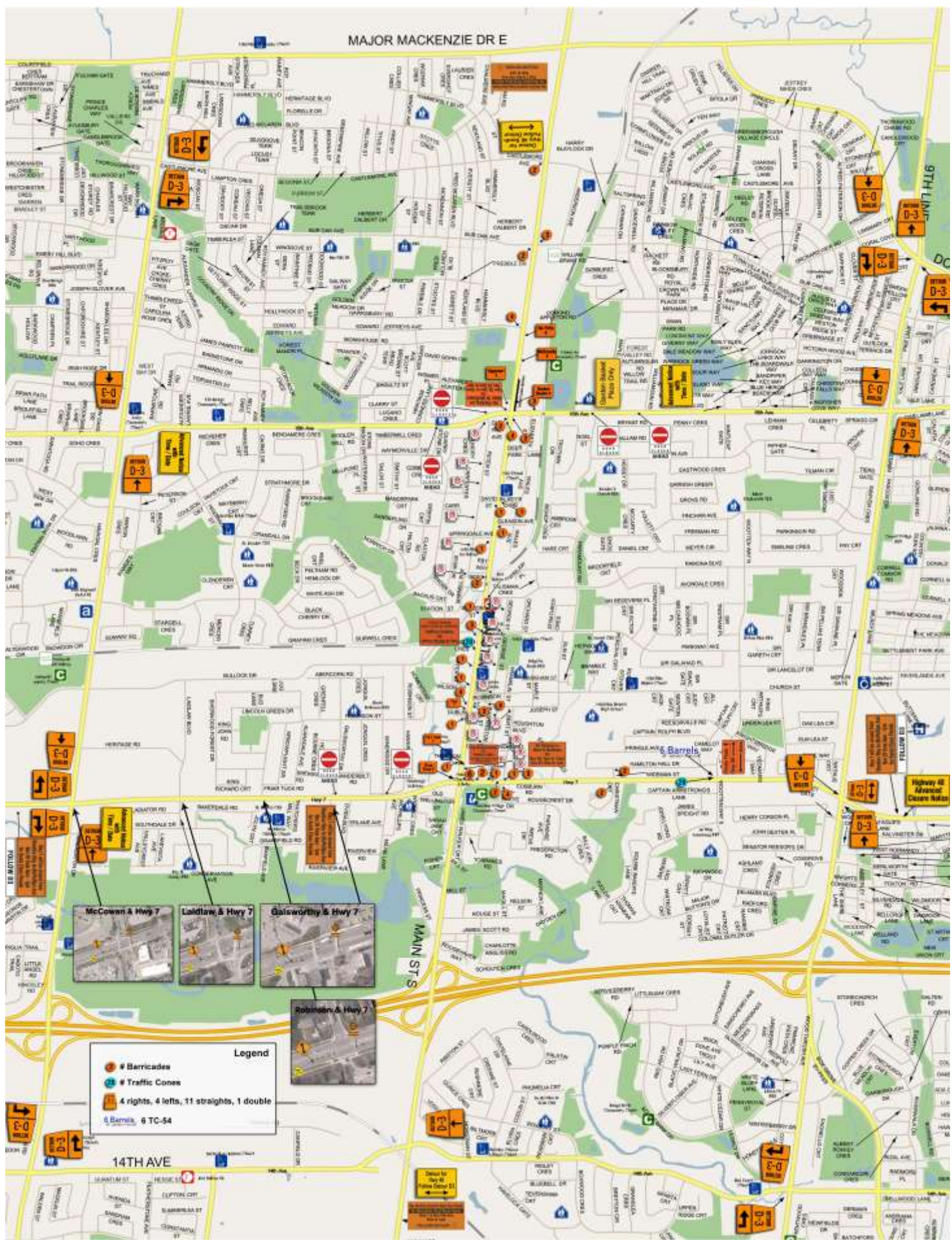

- Legend**
-  # Barricades
 -  # Traffic Cones
 -  4 rights, 4 lefts, 11 straights, 1 double
 -  Barricade 6 TC-54

14TH AVE

Galsworthy

Hwy 7



ROAD CLOSED
LOCAL TRAFFIC ONLY



OVER

Laidlaw

Hwy 7



ROAD CLOSED
LOCAL TRAFFIC ONLY



FRIAR

Robinson St

Hwy 7



ROAD CLOSED
LOCAL TRAFFIC ONLY



TC-53 = 4
TC-54 = 4
RB-92 = 1

Hawkrige Ave

Hwy 7 E

TC-53 = 2

TC-53 = 2

Wignall Cres

McPhillips Ave

Milne Lane

5189

5187

5180

5171

5173

2

